

Pipe sizing subject to further design changes

Legend	
	Existing Manhole
	Existing Pipe System
	Proposed Manhole
	Proposed Catchpit
	Proposed Headwall
	Proposed Pipe System

Size	A3	Scale	1:1500	Date	May 2021
No.	Amendment	Init.	Date	Designed	JMC
1	Issued for Resource Consent	JMC	17/05/21	Drawn	JMC
2	Updated Stormwater Line Locations	JMC	19/08/21	Checked	
3	Removed Lot 62, 63 & 69	JMC	30/03/22	Approved	

Resource Consent
Stormwater Overview
 Three Mile Bush Road, Kamo, Whangarei
 Prepared for: Hurupaki Holdings Ltd



Blue Wallace Surveyors Ltd.
 25 Harwood Street, P O Box 38,
 Hamilton Central, HAMILTON.
 Phone (07) 839 7799, Fax (07) 839 4455

Datum: Circuit: Mt Eden 2000	
Height: One Tree Point	
Resource Consent Number:	
.....	
BW Ref.	Stg. Purp. Dwg. # Revision:
20183-01-RC-500	3





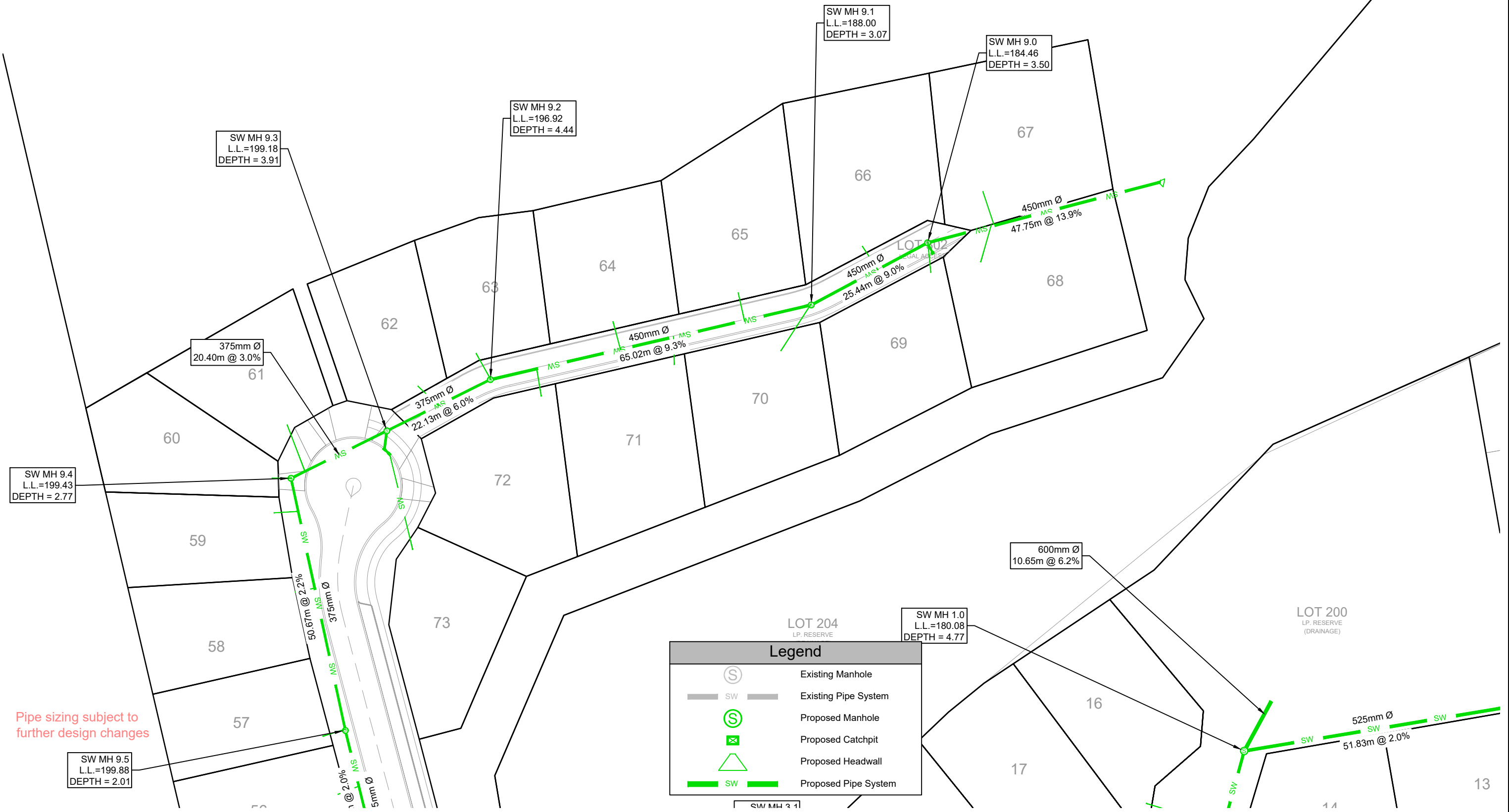

S:\2020\201832_ENGINEERING\1_DRAWINGS\PLOTTING DRAWINGS\20183-EN-01-500-SW.DWG

LOT 205
LP. RESERVE
(RECREATIONAL)



Pipe sizing subject to further design changes

Legend

-  Existing Manhole
-  Existing Pipe System
-  Proposed Manhole
-  Proposed Catchpit
-  Proposed Headwall
-  Proposed Pipe System

Size	A3	Scale	1:750	Date	May 2021		
No.	Amendment	Init.	Date	Designed	Drawn	JMC	
1	Issued for Resource Consent	JMC	17/05/21		JMC		
2	Updated Stormwater Line Locations	JMC	19/08/21	Checked			
3	Removed Lot 62, 63 & 69	JMC	30/03/22	Approved			

Resource Consent
Stormwater Layout
Three Mile Bush Road, Kamo, Whangarei
Prepared for: Hurupaki Holdings Ltd



Blue Wallace Surveyors Ltd.
25 Harwood Street, P O Box 38,
Hamilton Central, HAMILTON.
Phone (07) 839 7799, Fax (07) 839 4455

Datum: Circuit: Mt Eden 2000		Height: One Tree Point	
Resource Consent Number:			
.....			
BW Ref.	Stg.	Purp.	Dwg. #
			Revision:
20183-01-RC-501			3

S:\2020\201832_ENGINEERING\1_DRAWINGS\PLOTTING DRAWINGS\20183-EN-01-500-SW.DWG

S:\2020\201832_ENGINEERING\1_DRAWINGS\PLOTTING DRAWINGS\20183-EN-01-500-SW.DWG

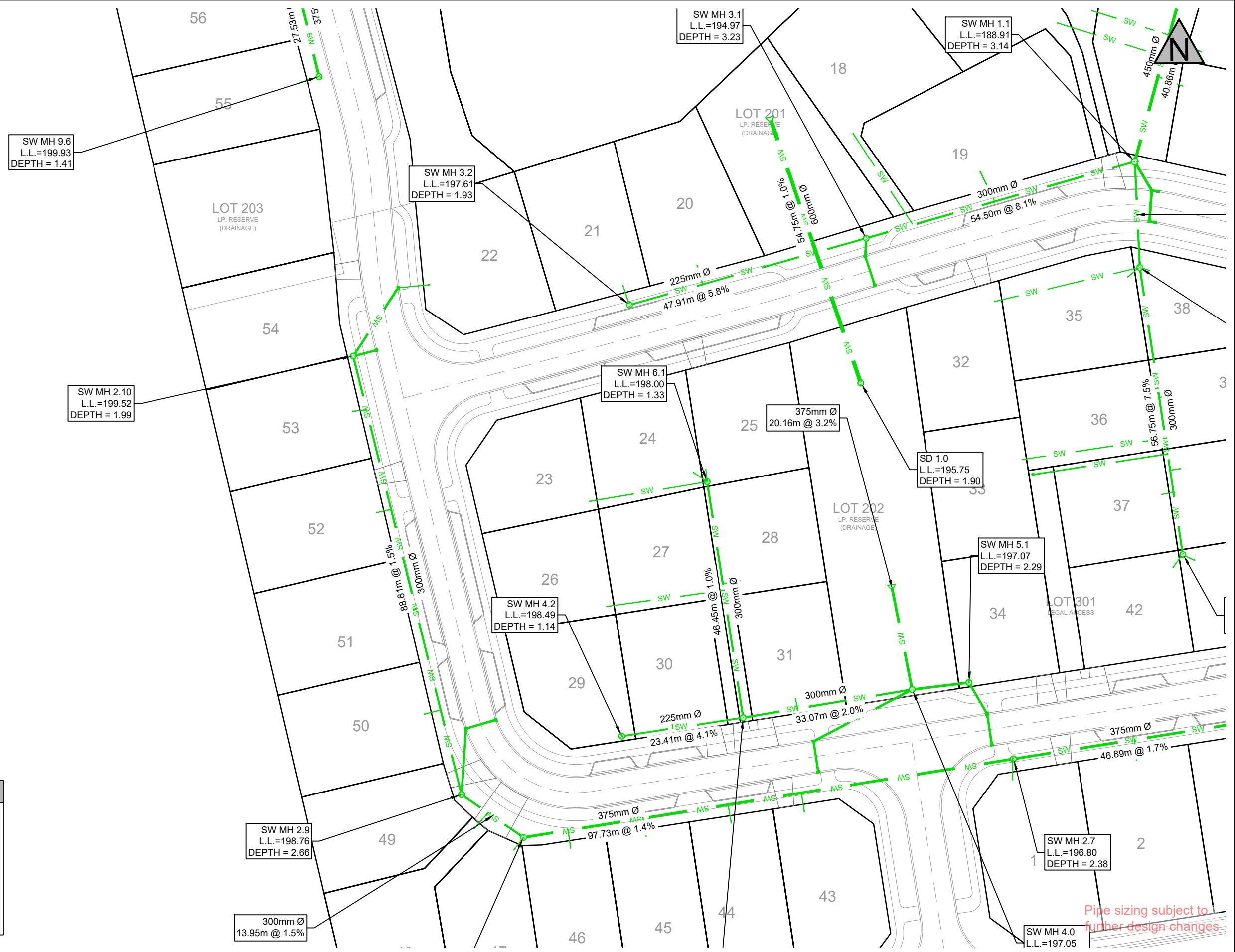

Legend	
	Existing Manhole
	Existing Pipe System
	Proposed Manhole
	Proposed Catchpit
	Proposed Headwall
	Proposed Pipe System

Size	A3	Scale	1:750	Date	May 2021		
No.	Amendment	Init.	Date	Designed	JMC		
1	Issued for Resource Consent	JMC	17/05/21	Drawn	JMC		
2	Updated Stormwater Line Locations	JMC	19/08/21	Checked			
3	Removed Lot 62, 63 & 69	JMC	30/03/22	Approved			

Resource Consent
Stormwater Layout
 Three Mile Bush Road, Kamo, Whangarei
 Prepared for: Hurupaki Holdings Ltd



Blue Wallace Surveyors Ltd.
 25 Harwood Street, P O Box 38,
 Hamilton Central, HAMILTON.
 Phone (07) 839 7799, Fax (07) 839 4455

Datum: Circuit; Mt Eden 2000	
Height: One Tree Point	
Resource Consent Number:	
.....	
BW Ref.	Stg. Purp. Dwg. # Revision:
20183-01-RC-502	3



Legend	
	Existing Manhole
	Existing Pipe System
	Proposed Manhole
	Proposed Catchpit
	Proposed Headwall
	Proposed Pipe System

Pipe sizing subject to further design changes

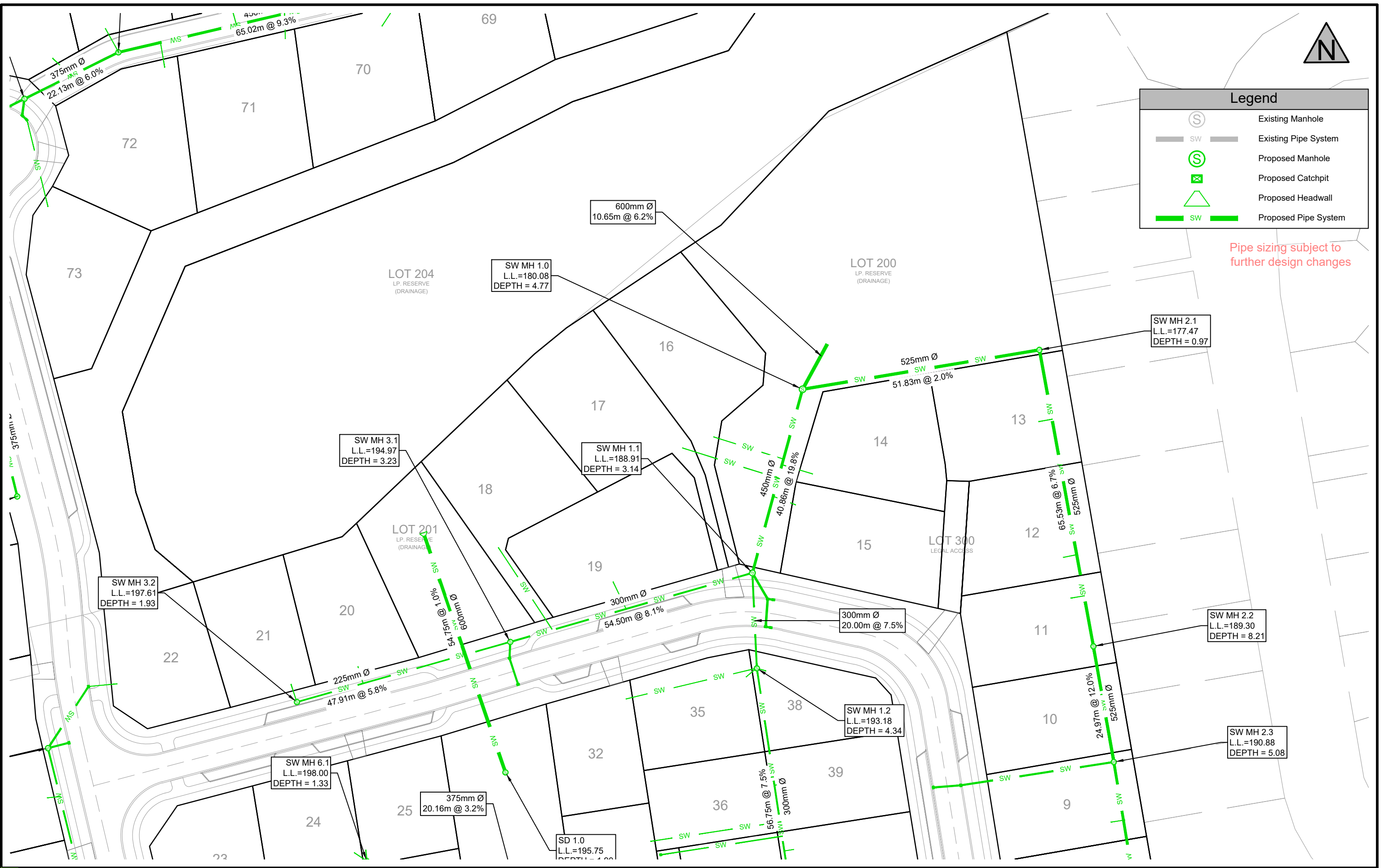

Size	A3	Scale	1:750	Date	May 2021
No.	Amendment	Init.	Date	Designed	JMC
1	Issued for Resource Consent	JMC	17/05/21	Drawn	JMC
2	Updated Stormwater Line Locations	JMC	19/08/21	Checked	
3	Removed Lot 62, 63 & 69	JMC	30/03/22	Approved	

Resource Consent
Stormwater Layout
 Three Mile Bush Road, Kamo, Whangarei
 Prepared for: Hurupaki Holdings Ltd



Blue Wallace Surveyors Ltd.
 25 Harwood Street, P O Box 38,
 Hamilton Central, HAMILTON.
 Phone (07) 839 7799, Fax (07) 839 4455

Datum: Circuit: Mt Eden 2000	
Height: One Tree Point	
Resource Consent Number:	
.....	
BW Ref.	Stg. Purp. Dwg. # Revision:
20183-01-RC-503	3

S:\2020\201832_ENGINEERING\1_DRAWINGS\PLOTING DRAWINGS\20183-EN-01-500-SW.DWG

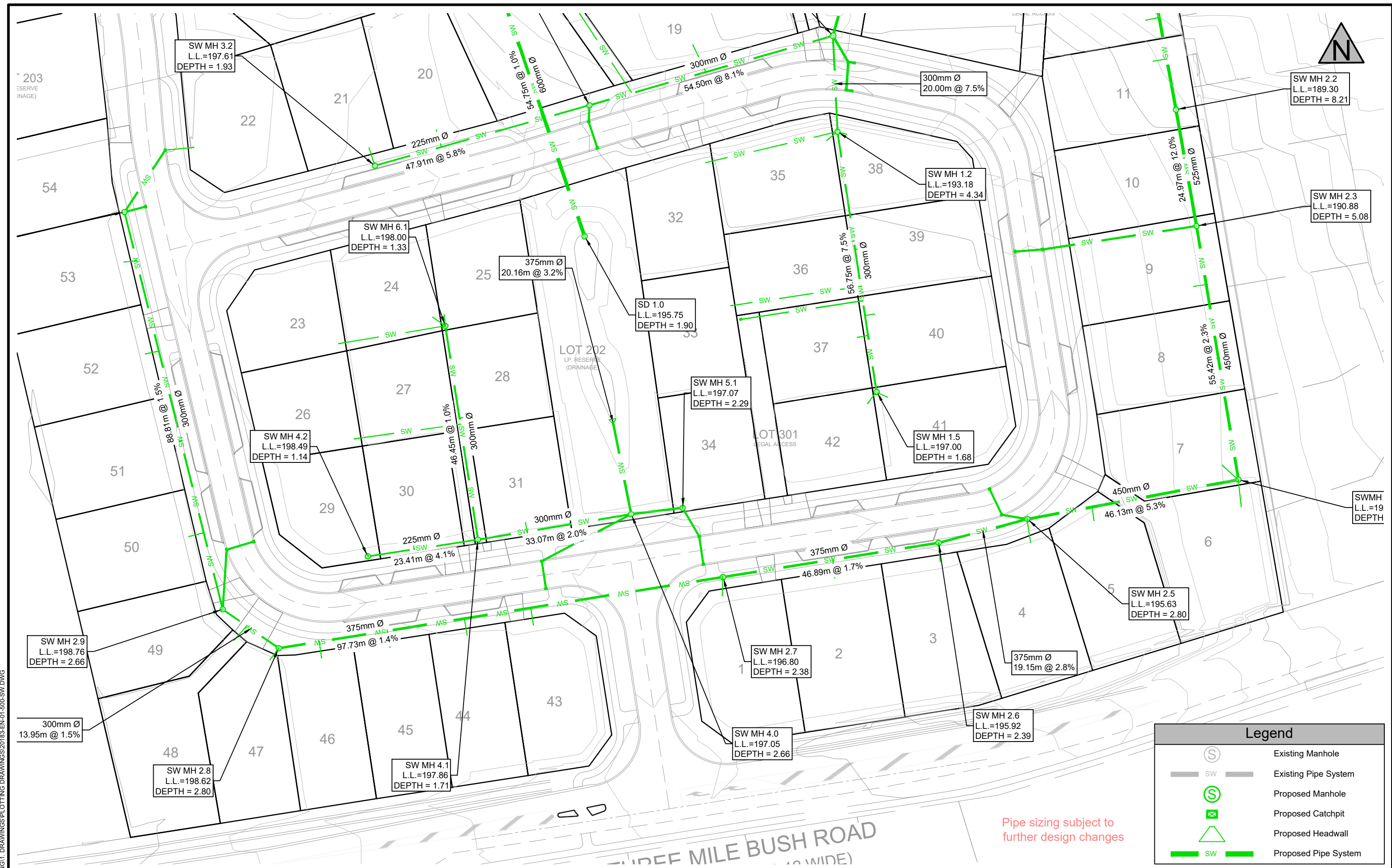

Legend	
	Existing Manhole
	Existing Pipe System
	Proposed Manhole
	Proposed Catchpit
	Proposed Headwall
	Proposed Pipe System

S:\2020\201832_ENGINEERING\1_DRAWINGS\1_PLOTTING\DRAWINGS\201832-EN-01-500-SW.DWG

Size	A3	Scale	1:750	Date	May 2021		
No.	Amendment	Init.	Date	Designed	Drawn	JMC	
1	Issued for Resource Consent	JMC	17/05/21		JMC		
2	Updated Stormwater Line Locations	JMC	19/08/21	Checked			
3	Removed Lot 62, 63 & 69	JMC	30/03/22	Approved			

Resource Consent
Stormwater Layout
 Three Mile Bush Road, Kamo, Whangarei
 Prepared for: Hurupaki Holdings Ltd



Blue Wallace
Surveyors Ltd.
 25 Harwood Street, P O Box 38,
 Hamilton Central, HAMILTON.
 Phone (07) 839 7799, Fax (07) 839 4455

Datum: Circuit: Mt Eden 2000	
Height: One Tree Point	
Resource Consent Number:	
.....	
BW Ref.	Stg. Purp. Dwg. # Revision:
20183-01-RC-504	3