

13. New Road Names – Resource Consents

Reporting officer Linda Wheeler (Team Leader – Support, Resource Consents)

Date of meeting 12 June 2013

Vision, mission and values

This item is in accord with Council's vision, mission and values statement as it supports clear and unambiguous property addressing for emergency and utility services, contributing to community safety and well being.

Applications for the naming of new roads have been received for the following resource consent:

Blue Wallace Surveyors Ltd – Totara Parklands – SD1200080

Public Roads – Proposed road names

Road A: Wairau Drive
Road B: Okaihau Place
Road D: Maui Place
Road E: Lake Drive
Road F: Rotokauri Rise
Road H: Timara Avenue

It is noted that the applicant has chosen to name the roads after lakes of New Zealand. Some initial consultation with local Iwi regarding the possible use of locally derived Maori names appears to have been undertaken. However advice was then received indicating that local Iwi did not wish to be involved with the road naming.

As the subdivision is staged, further road names for other parts of the development will be required at a later date. It is expected that these road names will follow the same theme.

Recommendation

That the new public road A at Totara Parklands Tikipunga be named Wairau Drive
That the new public road B at Totara Parklands Tikipunga be named Okaihau Place
That the new public road D at Totara Parklands Tikipunga be named Maui Place
That the new public road E at Totara Parklands Tikipunga be named Lake Drive
That the new public road F at Totara Parklands Tikipunga be named Rotokauri Rise
That the new public road H at Totara Parklands Tikipunga be named Timara Avenue

Attachments:

[Application and road map for subdivision located at Corks Road Tikipunga](#)



Our Ref: 11/008
14 May 2013

Paul Lees
Whangarei District Council
Private bag 9023
Whangarei 0148

Attention: Paul Lees

Dear Paul,

RE: TOTARA PARKLANDS - ROAD NAME APPLICATION

In accordance with Consent condition 5i of Resource Consent SD1200080, please see below the developers choices of road names within Stage 1 and 1A for the Totara Parklands subdivision. All roads are to be vested in Council. We have enclosed a overall scheme plan as well as the scheme plan for the current stage showing each road's location.

Road Name	Choice 1	Choice 2	Choice 3
Road A	Wairau Drive	Wainui Drive	Dunstan Drive
Road B	Okaihau Place	Ohau Place	Daniell Place
Road D	Maui Place	Sumner Place	Ida Place
Road E	Lake Drive	Lagoon Drive	Pahau Drive
Road F	Rotokauri Rise	Waikare Rise	Hanlon Heights
Road H	Timara Avenue	Tama Avenue	Hawdon Avenue

All roads have been named after New Zealand lakes.

Regards,

Blue Wallace Surveyors Ltd

Charlotte Nijssen
Licensed Cadastral Surveyor
charlotte@bluewallace.co.nz

John Blue Chartered
Murray Wallace Chartered
Tony Tynan Chartered

25 Harwood Street
PO Box 38, Hamilton
Ph: 07 839 7799
Fax: 07 839 4455
www.bluewallace.co.nz

- * Registered Land & Engineering Surveyors
- * Land Development Consultants
- * Resource Management Planners
- * Members of the Consulting Surveyors of New Zealand
- * Registered Professional Surveyors



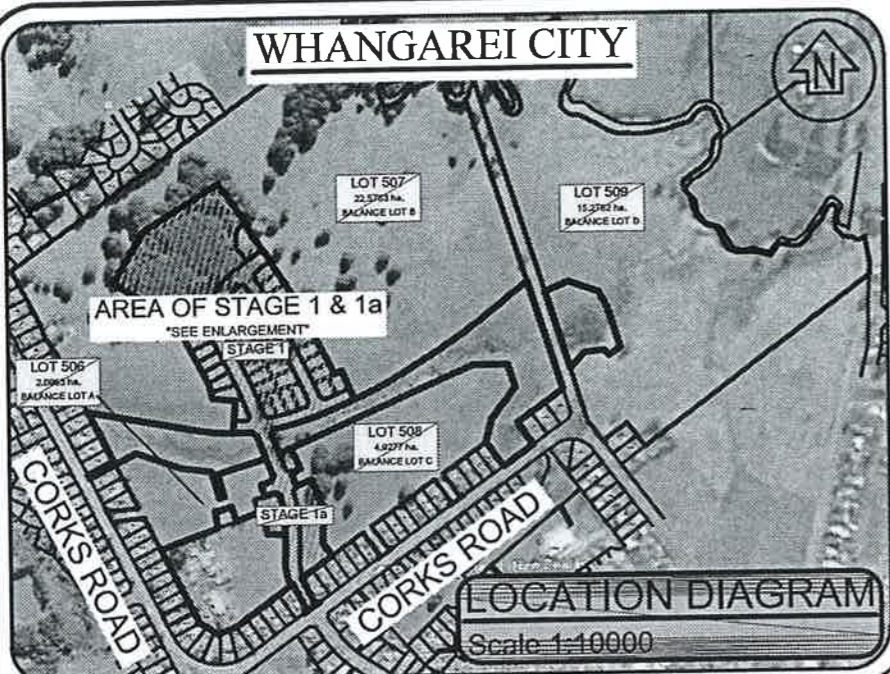

AMALGAMATION CONDITION
THAT LOT 502 HEREON & LOT 26 DP 48880 (RESIDUE CT. 430764) BE HELD IN ONE CERTIFICATE OF TITLE.
(SEE REQUEST..... 1107373.....)

AMALGAMATION CONDITION
THAT LOTS 506 - 509 HEREON (BALANCE LOTS A - D) BE HELD IN ONE CERTIFICATE OF TITLE.
(SEE REQUEST..... 1107373.....)

MEMORANDUM OF EASEMENT IN GROSS

PURPOSE	SERV. TENE.	SHOWN	GRANTEE
RIGHT OF WAY	LOT 506 HEREON	A	WHANGAREI DISTRICT COUNCIL
	LOT 507 HEREON	C - F	

- NOTE:**
- ALL AREAS AND DIMENSIONS SUBJECT TO FINAL SURVEY AND APPROVAL FROM THE WHANGAREI DISTRICT COUNCIL
 - LEGAL DESCRIPTION: LOT 1
DP 369692
AREA: 20.1780 ha.
(CT. 359907)
 - LOT 2
DP 369692
AREA: 20.6530 ha.
(CT. 359908)
 - PT LOT 7
DP 1583
&
LOT 26
DP 48880
AREA: 2.2692 ha.
(CT. 430764)
 - PT LOT 6
DP 1583
AREA: 16.1272 ha.
(CT. NA3D/187)
 - TOTAL AREA: 59.2274 ha.
 - ZONE: LIVING ZONE 1
 - AERIAL PHOTO SUBJECT TO DISTORTION
 - ALL LEVELS ARE IN TERMS OF ONE TREE POINT DATUM 1964

NOMINATED SUPERVISOR
ENGINEERING PLANS FOR CONSTRUCTION

NAME: MURRAY WALLACE - REGISTERED PROFESSIONAL SURVEYOR
ADDRESS: 25 HARWOOD STREET, HAMILTON
E-MAIL: murray@bluewallace.co.nz
PHONE: Wk. (07) 839 7799 Mob. 021 823 768

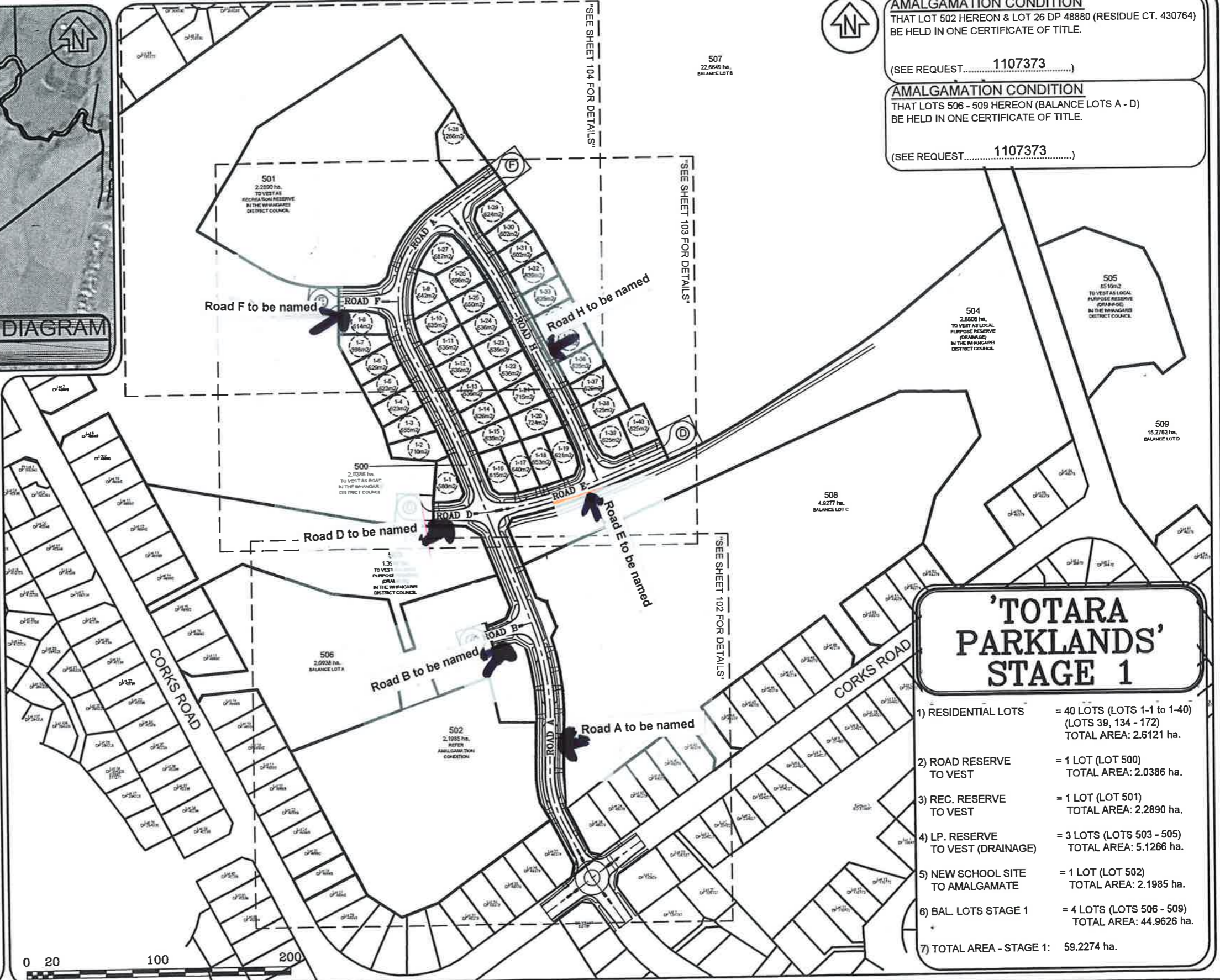

- RESIDENTIAL LOTS = 40 LOTS (LOTS 1-1 to 1-40) (LOTS 39, 134 - 172) TOTAL AREA: 2.6121 ha.
- ROAD RESERVE TO VEST = 1 LOT (LOT 500) TOTAL AREA: 2.0386 ha.
- REC. RESERVE TO VEST = 1 LOT (LOT 501) TOTAL AREA: 2.2890 ha.
- LP. RESERVE TO VEST (DRAINAGE) = 3 LOTS (LOTS 503 - 505) TOTAL AREA: 5.1266 ha.
- NEW SCHOOL SITE TO AMALGAMATE = 1 LOT (LOT 502) TOTAL AREA: 2.1985 ha.
- BAL. LOTS STAGE 1 = 4 LOTS (LOTS 506 - 509) TOTAL AREA: 44.9626 ha.
- TOTAL AREA - STAGE 1: 59.2274 ha.

SCALE: 1:3000 @A3 DATE: JANUARY 2013

No.	Amendment	Init.	Date.	Designed. WAB
1	ENG-REVISION #5 - PROPOSED SITE PLAN	WAB	01/13	Drawn. WAB 9 JANUARY 2013
2				Checked.
3				Approved.

PROPOSED ENGINEERING WORKS - STAGE 1
PROPOSED OVERALL SITE PLAN
CORKS ROAD - WHANGAREI
PREPARED FOR: TOTARA PARKLANDS ESTATE LTD.

Firm's Name  **Blue Wallace**
Surveyors Ltd.
25 Harwood Street, P O Box 38,
Hamilton Central, HAMILTON.
Phone (07) 839 7799, Fax (07) 839 4455

File Reference 11/008
Sheet No. 101