

KEY	
	RECREATIONAL RESERVE (WDC)
	RECREATIONAL RESERVE (CROWN)
	RECREATIONAL RESERVE (DOC)
	RIVER
	ESPLANADE
	MAORI LAND

NOTE:
ALL OTHER LAND IS PRIVATE PROPERTY

WHANGAREI DISTRICT COUNCIL SPEED LIMITS BYLAW	
SCALE BAR:	
<p>1. SCALES SHOWN ON THIS MAP ARE APPROXIMATE.</p> <p>2. DIMENSIONS SHOW THE BOUNDARIES OF A SPEED LIMIT FOR THE PURPOSE OF THE BYLAW.</p> <p>3. SPEED LIMIT BOUNDARIES THAT CROSS A ROAD DO SO AT RIGHT ANGLES FROM THE SIDE TO THE OPPOSITE SIDE OF THE ROAD BY THE SHORTEST DISTANCE.</p> <p>4. A SPEED LIMIT BOUNDARY MARKED ALONG A ROAD IS DEEMED TO RUN ALONG THE CHANGEMENY EDGE OF THAT ROAD UNLESS DIMENSIONED OR SHOWN OTHERWISE.</p> <p>5. WHERE NO DIMENSION OR DISTANCE IS GIVEN OR SHOWN WHEN THE SPEED LIMIT CROSSES A ROAD AT A SIDE ROAD, THE SPEED LIMIT IS DEEMED TO CROSS THE ROAD AT THE EXTENSION OF THE SIDE ROAD CHANGEMENY EDGE.</p> <p>6. WHERE THE BOUNDARY BETWEEN THE WHANGAREI DISTRICT AND KAPARA DISTRICT AND THE NORTH DISTRICT RUNS ALONG A ROAD, THIS PLAN AND BYLAW APPLY TO THE WHOLE WIDTH OF THE ROAD.</p> <p>7. WHERE A ROAD CROSSES UNDER OR OVER A STATE HIGHWAY OR EXPRESSWAY, THE SPEED LIMIT ON THAT ROAD AT THAT LOCATION IS DEEMED TO BE THE SAME AS FOR THE ADJOINING SECTIONS OF EITHER SIDE OF THE STATE HIGHWAY OR EXPRESSWAY UNLESS DIMENSIONED OR SHOWN OTHERWISE.</p> <p>8. ALL WHANGAREI DISTRICT COUNCIL ROADS SHOWN ON THIS MAP OUTSIDE THE URBAN TRAFFIC AREAS HAVE A SPEED LIMIT OF 100 km/h, UNLESS MARKED WITH A DIFFERENT SPEED LIMIT.</p> <p>9. SPEED LIMITS ON STATE HIGHWAYS ARE NOT PART OF THIS BYLAW. THEY ARE SHOWN ON THIS MAP FOR INFORMATION ONLY. REFER TO TRAFFIC NEW ZEALAND SPEED LIMIT BYLAWS FOR SPEED LIMITS ON STATE HIGHWAYS.</p> <p>10. THIS MAP IS PART OF THE WHANGAREI DISTRICT COUNCIL SPEED LIMIT BYLAW 2005.</p> <p>11. REFER TO SCHEDULES:</p> <p>WDC 54/1 TO 54/29; WDC 55/1; WDC 56/1 TO 56/13; WDC 57/1 TO 57/8; WDC 58/1; AND WDC 512/1 TO 512/7.</p>	
<p>LEGEND</p> <p> ROADS THAT HAVE A SPEED LIMIT OF 30 km/h.</p> <p> ROADS THAT HAVE A VARIABLE SPEED LIMIT OF 40 km/h, ROADS WITHIN A SCHOOL ZONE WHICH DECREASE TO 40 km/h DURING THE SCHOOL ZONE.</p> <p> BOUNDARY OF THE URBAN TRAFFIC AREAS THAT HAVE A SPEED LIMIT OF 50 km/h, EXCEPT FOR ROADS OR AREAS MARKED WITH A DIFFERENT SPEED LIMIT.</p> <p> ROADS THAT HAVE A SPEED LIMIT OF 8 km/h DURING WINTER AND 7 km/h DURING THE SUMMER HOLIDAY PERIOD. SUMMER HOLIDAY PERIOD STARTS THE FRIDAY BEFORE LABOUR WEEKEND AND ENDS FRIDAY AFTER EASTER WEEKEND.</p> <p> ROADS THAT HAVE A SPEED LIMIT OF 60 km/h.</p> <p> ROADS THAT HAVE A SPEED LIMIT OF 70 km/h.</p> <p> ROADS THAT HAVE A SPEED LIMIT OF 80 km/h.</p> <p> ROADS THAT HAVE A SPEED LIMIT OF 100 km/h.</p> <p> STATE HIGHWAYS. REFER TO THE TRAFFIC NEW ZEALAND SPEED LIMIT BYLAWS FOR SPEED LIMITS.</p> <p> PRIVATE (PVT) ROAD.</p> <p> DISTRICT BOUNDARY WHERE IT ADJUTS TO AN ADJACENT TERRITORIAL LOCAL AUTHORITY.</p> <p> DISTANCE IN METRES FROM THE CENTRELINE OF AN INTERSECTING ROAD OR A GEOGRAPHICAL FEATURE SHOWN ON THE MAP TO THE SPEED LIMIT BOUNDARY.</p>	

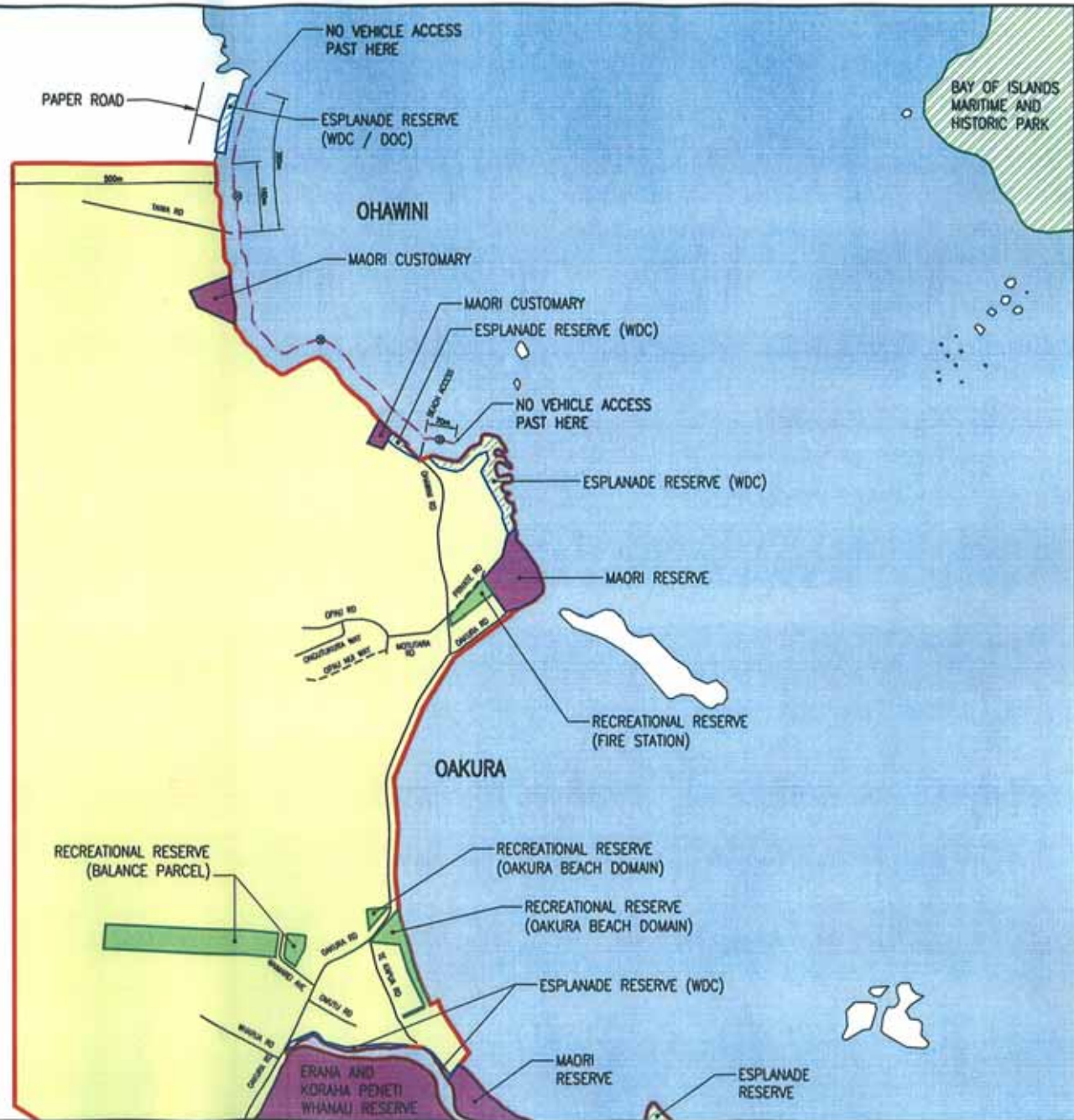

OHAWINI AND OAKURA
DISTRICT SPEED LIMIT LOCATIONS
WDC 08/01 SHEET 10A

DATE: 20/05/08
SCALE: 1:10,000



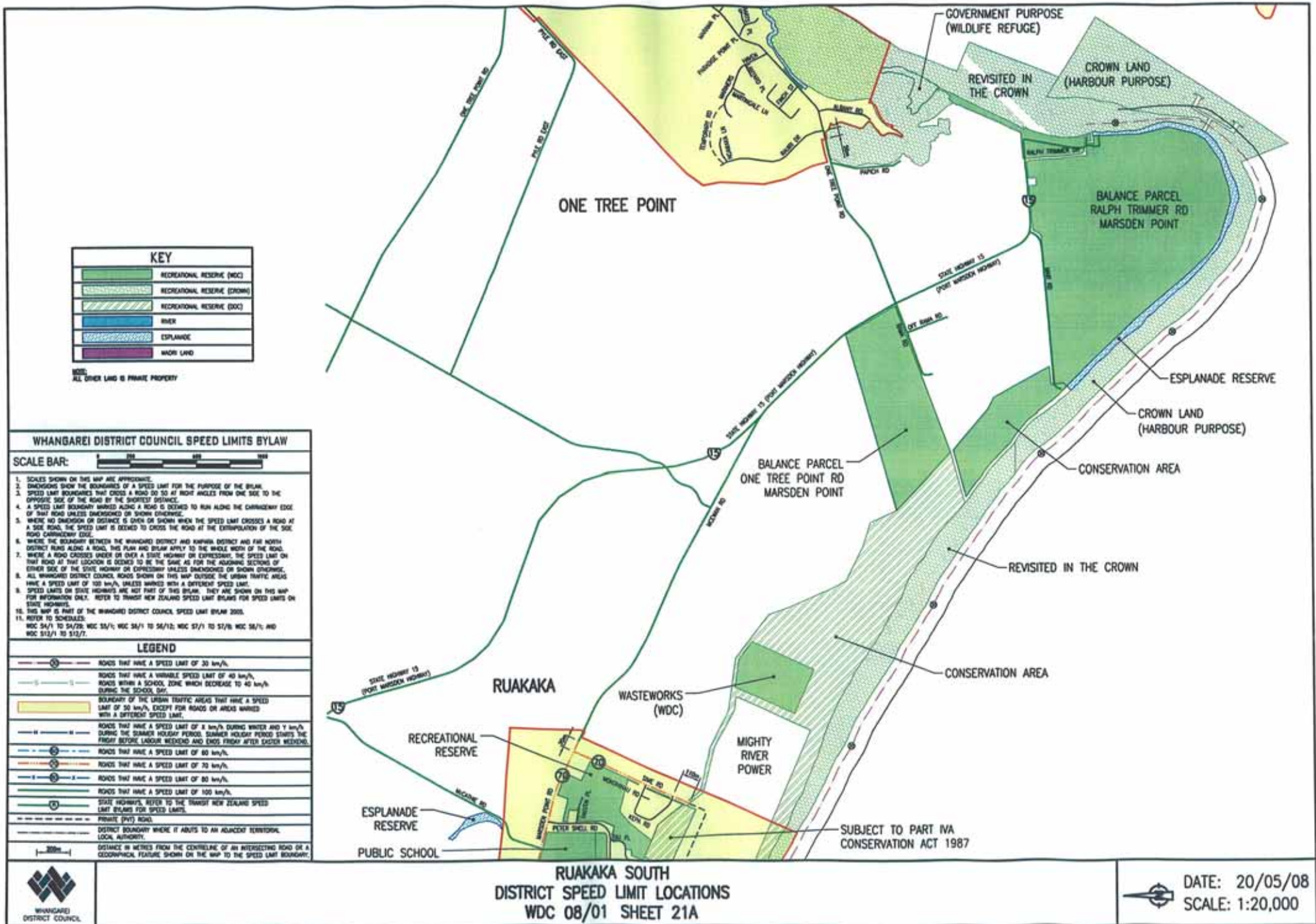

KEY	
[Green hatched box]	RECREATIONAL RESERVE (MDC)
[Green hatched box]	RECREATIONAL RESERVE (DROM)
[Green hatched box]	RECREATIONAL RESERVE (DOC)
[Blue hatched box]	RIVER
[Blue hatched box]	ESPLANADE
[Purple hatched box]	MARU LAND

NOTE: ALL OTHER LAND IS PRIVATE PROPERTY

WHANGAREI DISTRICT COUNCIL SPEED LIMITS BYLAW

- SCALE BAR: 0 100 200 300
1. SCALES SHOWN ON THIS MAP ARE APPROXIMATE.
 2. DIMENSIONS SHOW THE BOUNDARIES OF A SPEED LIMIT FOR THE PURPOSE OF THE BYLAW.
 3. SPEED LIMIT BOUNDARIES THAT CROSS A ROAD DO SO AT RIGHT ANGLES FROM ONE SIDE TO THE OPPOSITE SIDE OF THE ROAD BY THE SHORTEST DISTANCE.
 4. A SPEED LIMIT BOUNDARY MARKED ALONG A ROAD IS DEEMED TO RUN ALONG THE CARRIAGEWAY EDGE OF THAT ROAD UNLESS DIMENSIONED OR SHOWN OTHERWISE.
 5. WHERE NO DIMENSION OR DISTANCE IS GIVEN OR SHOWN WHEN THE SPEED LIMIT CROSSES A ROAD AT A SIDE ROAD, THE SPEED LIMIT IS DEEMED TO CROSS THE ROAD AT THE EXTRAPOLATION OF THE SIDE ROAD CARRIAGEWAY EDGE.
 6. WHERE THE BOUNDARY BETWEEN THE WHANGAREI DISTRICT AND KAWHIA DISTRICT AND FINE NORTH DISTRICT RUNS ALONG A ROAD, THIS PLAN HAS BEEN APPLIED TO THE WHOLE WIDTH OF THE ROAD.
 7. WHERE A ROAD CROSSES UNDER OR OVER A STATE HIGHWAY OR EXPRESSWAY, THE SPEED LIMIT ON THAT ROAD AT THAT LOCATION IS DEEMED TO BE THE SAME AS FOR THE ADJOINING SECTIONS OF EITHER SIDE OF THE STATE HIGHWAY OR EXPRESSWAY UNLESS DIMENSIONED OR SHOWN OTHERWISE.
 8. ALL WHANGAREI DISTRICT COUNCIL ROADS SHOWN ON THIS MAP OUTSIDE THE URBAN TRAFFIC AREAS HAVE A SPEED LIMIT OF 100 km/h, UNLESS MARKED WITH A DIFFERENT SPEED LIMIT.
 9. SPEED LIMITS ON STATE HIGHWAYS ARE NOT PART OF THIS BYLAW. THEY ARE SHOWN ON THIS MAP FOR INFORMATION ONLY. REFER TO THIRDS NEW ZEALAND SPEED LIMIT BYLAWS FOR SPEED LIMITS ON STATE HIGHWAYS.
 10. THIS MAP IS PART OF THE WHANGAREI DISTRICT COUNCIL SPEED LIMIT BYLAW 2005.
 11. REFER TO SCHEDULES:
MDC 54/1 TO 54/26; MDC 55/1; MDC 56/1 TO 56/12; MDC 57/1 TO 57/6; MDC 58/1; AND MDC 512/1 TO 512/7.

LEGEND	
[Solid line with 30 km/h sign]	ROADS THAT HAVE A SPEED LIMIT OF 30 km/h.
[Dashed line with 40 km/h sign]	ROADS THAT HAVE A VARIABLE SPEED LIMIT OF 40 km/h, ROADS WITHIN A SCHOOL ZONE WHICH DECREASE TO 40 km/h DURING THE SCHOOL DAY.
[Yellow shaded area]	BOUNDARY OF THE URBAN TRAFFIC AREAS THAT HAVE A SPEED LIMIT OF 50 km/h, EXCEPT FOR ROADS OR AREAS MARKED WITH A DIFFERENT SPEED LIMIT.
[Dashed line with 60 km/h sign]	ROADS THAT HAVE A SPEED LIMIT OF 60 km/h DURING WINTER AND 70 km/h DURING THE SUMMER HOLIDAY PERIOD. SUMMER HOLIDAY PERIOD STARTS THE FRIDAY BEFORE LABOUR WEEKEND AND ENDS FRIDAY AFTER EASTER WEEKEND.
[Dashed line with 70 km/h sign]	ROADS THAT HAVE A SPEED LIMIT OF 70 km/h.
[Dashed line with 80 km/h sign]	ROADS THAT HAVE A SPEED LIMIT OF 80 km/h.
[Dashed line with 90 km/h sign]	ROADS THAT HAVE A SPEED LIMIT OF 90 km/h.
[Dashed line with 100 km/h sign]	ROADS THAT HAVE A SPEED LIMIT OF 100 km/h.
[Green hatched box]	STATE HIGHWAYS, REFER TO THE THIRDS NEW ZEALAND SPEED LIMIT BYLAWS FOR SPEED LIMITS.
[Dashed line]	PRIVATE (PVT) ROAD.
[Dashed line]	DISTRICT BOUNDARY WHERE IT ADJUTS TO AN ADJACENT TERRITORIAL LOCAL AUTHORITY.
[Dashed line]	DISTANCE IN METRES FROM THE CENTRELINE OF AN INTERSECTING ROAD OR A GEOGRAPHICAL FEATURE SHOWN ON THE MAP TO THE SPEED LIMIT BOUNDARY.

**RUAKAKA SOUTH
DISTRICT SPEED LIMIT LOCATIONS
WDC 08/01 SHEET 21A**

DATE: 20/05/08
SCALE: 1:20,000



KEY	
	RECREATIONAL RESERVE (WDC)
	RECREATIONAL RESERVE (CROWN)
	RECREATIONAL RESERVE (DOC)
	RIVER
	ESPLANADE
	MORI LAND

NOTE:
ALL OTHER LAND IS PRIVATE PROPERTY

WHANGAREI DISTRICT COUNCIL SPEED LIMITS BYLAW

SCALE BAR:

1. SCALES SHOWN ON THIS MAP ARE APPROXIMATE.
2. DIMENSIONS SHOW THE BOUNDARIES OF A SPEED LIMIT FOR THE PURPOSE OF THE BYLAW.
3. SPEED LIMIT BOUNDARIES THAT CROSS A ROAD DO SO AT RIGHT ANGLES FROM ONE SIDE TO THE OPPOSITE SIDE OF THE ROAD BY THE SHORTEST DISTANCE.
4. A SPEED LIMIT BOUNDARY MARKED ALONG A ROAD IS DEEMED TO RUN ALONG THE CARBONADOY EDGE OF THAT ROAD UNLESS DIMENSIONED OR SHOWN OTHERWISE.
5. WHERE NO DIMENSION OR DISTANCE IS GIVEN OR SHOWN WHEN THE SPEED LIMIT CROSSES A ROAD AT A SIDE ROAD, THE SPEED LIMIT IS DEEMED TO CROSS THE ROAD AT THE EXTENSION OF THE SIDE ROAD CARBONADOY EDGE.
6. WHERE THE BOUNDARY BETWEEN THE WHANGAREI DISTRICT AND HAPUNA DISTRICT AND THE NORTH DISTRICT RUNS ALONG A ROAD, THIS PLAN AND BYLAW APPLY TO THE WHOLE WIDTH OF THE ROAD.
7. WHERE A ROAD CROSSES UNDER OR OVER A STATE HIGHWAY OR EXPRESSWAY, THE SPEED LIMIT ON THAT ROAD AT THAT LOCATION IS DEEMED TO BE THE SAME AS FOR THE ADJOINING SECTIONS OF EITHER SIDE OF THE STATE HIGHWAY OR EXPRESSWAY UNLESS DIMENSIONED OR SHOWN OTHERWISE.
8. ALL WHANGAREI DISTRICT COUNCIL ROADS SHOWN ON THIS MAP OUTSIDE THE URBAN TRAFFIC AREAS HAVE A SPEED LIMIT OF 100 km/h, UNLESS MARKED WITH A DIFFERENT SPEED LIMIT.
9. SPEED LIMITS ON STATE HIGHWAYS ARE NOT PART OF THIS BYLAW. THEY ARE SHOWN ON THIS MAP FOR INFORMATION ONLY. REFER TO TRANSPORT NEW ZEALAND SPEED LIMIT BYLAWS FOR SPEED LIMITS ON STATE HIGHWAYS.
10. THIS MAP IS PART OF THE WHANGAREI DISTRICT COUNCIL SPEED LIMIT BYLAW 2005.
11. REFER TO SCHEDULES:
WDC 34/1 TO 34/29; WDC 35/1; WDC 36/1 TO 36/12; WDC 37/1 TO 37/6; WDC 38/1; AND WDC 39/1 TO 39/7.

LEGEND

- ROADS THAT HAVE A SPEED LIMIT OF 30 km/h.
- ROADS THAT HAVE A VARIABLE SPEED LIMIT OF 40 km/h, ROADS WITHIN A SCHOOL ZONE WHICH DECREASE TO 40 km/h DURING THE SCHOOL DAY.
- BOUNDARY OF THE URBAN TRAFFIC AREAS THAT HAVE A SPEED LIMIT OF 50 km/h, EXCEPT FOR ROADS OR AREAS MARKED WITH A DIFFERENT SPEED LIMIT.
- ROADS THAT HAVE A SPEED LIMIT OF 80 km/h DURING WINTER AND 100 km/h DURING THE SUMMER HOLIDAY PERIOD. SUMMER HOLIDAY PERIOD STARTS THE FRIDAY BEFORE LABOUR WEEKEND AND ENDS FRIDAY AFTER EASTER WEEKEND.
- ROADS THAT HAVE A SPEED LIMIT OF 80 km/h.
- ROADS THAT HAVE A SPEED LIMIT OF 70 km/h.
- ROADS THAT HAVE A SPEED LIMIT OF 60 km/h.
- ROADS THAT HAVE A SPEED LIMIT OF 50 km/h.
- ROADS THAT HAVE A SPEED LIMIT OF 40 km/h.
- ROADS THAT HAVE A SPEED LIMIT OF 30 km/h.
- STATE HIGHWAYS. REFER TO THE TRANSPORT NEW ZEALAND SPEED LIMIT BYLAWS FOR SPEED LIMITS.
- PRIVATE (PVT) ROAD.
- DISTRICT BOUNDARY WHERE IT ADJUTS TO AN ADJACENT TERRITORIAL LOCAL AUTHORITY.



RUAKAKA NORTH DISTRICT SPEED LIMIT LOCATIONS WDC 08/01 SHEET 21B



DATE: 20/05/08
SCALE: 1:20,000

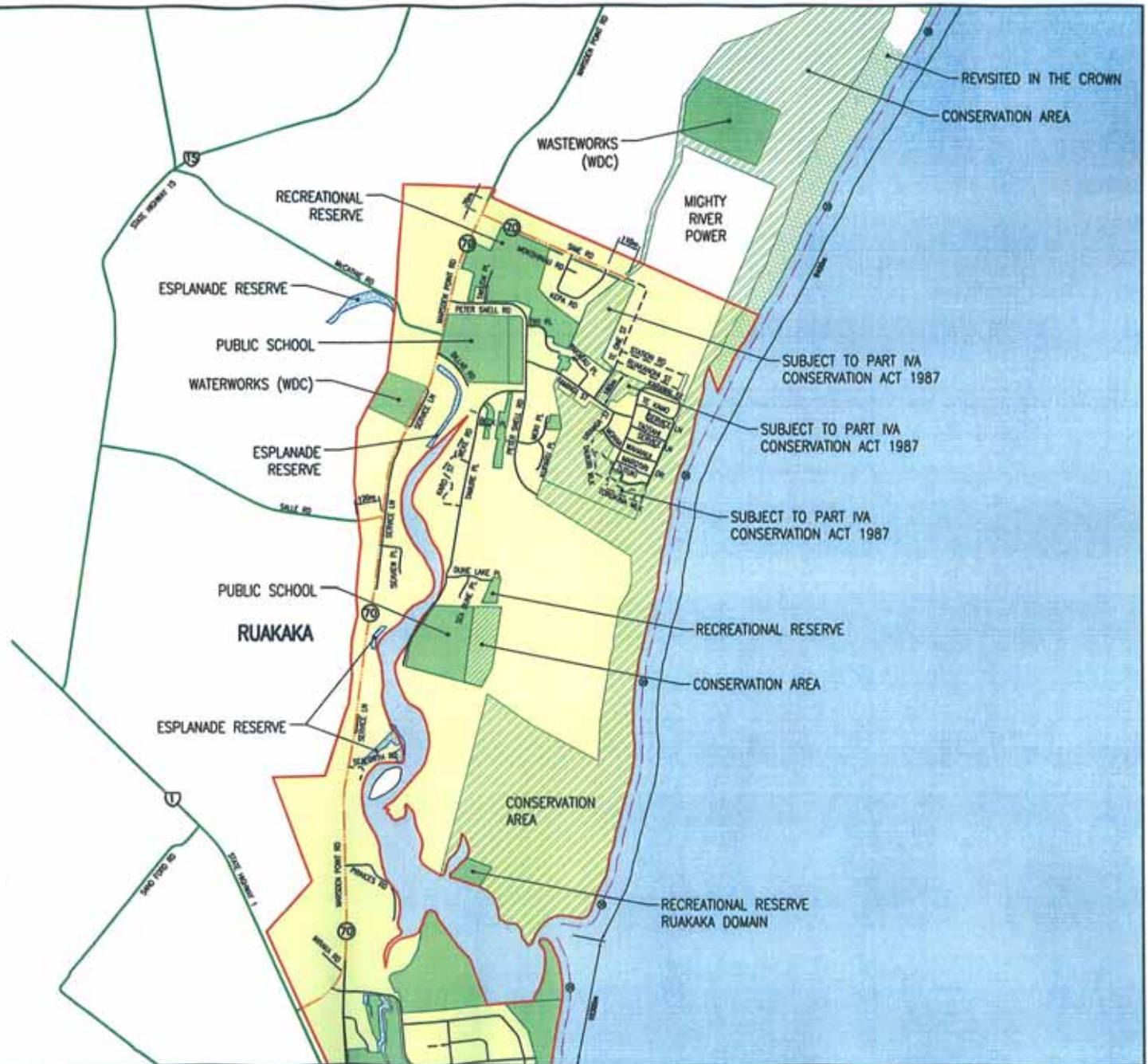

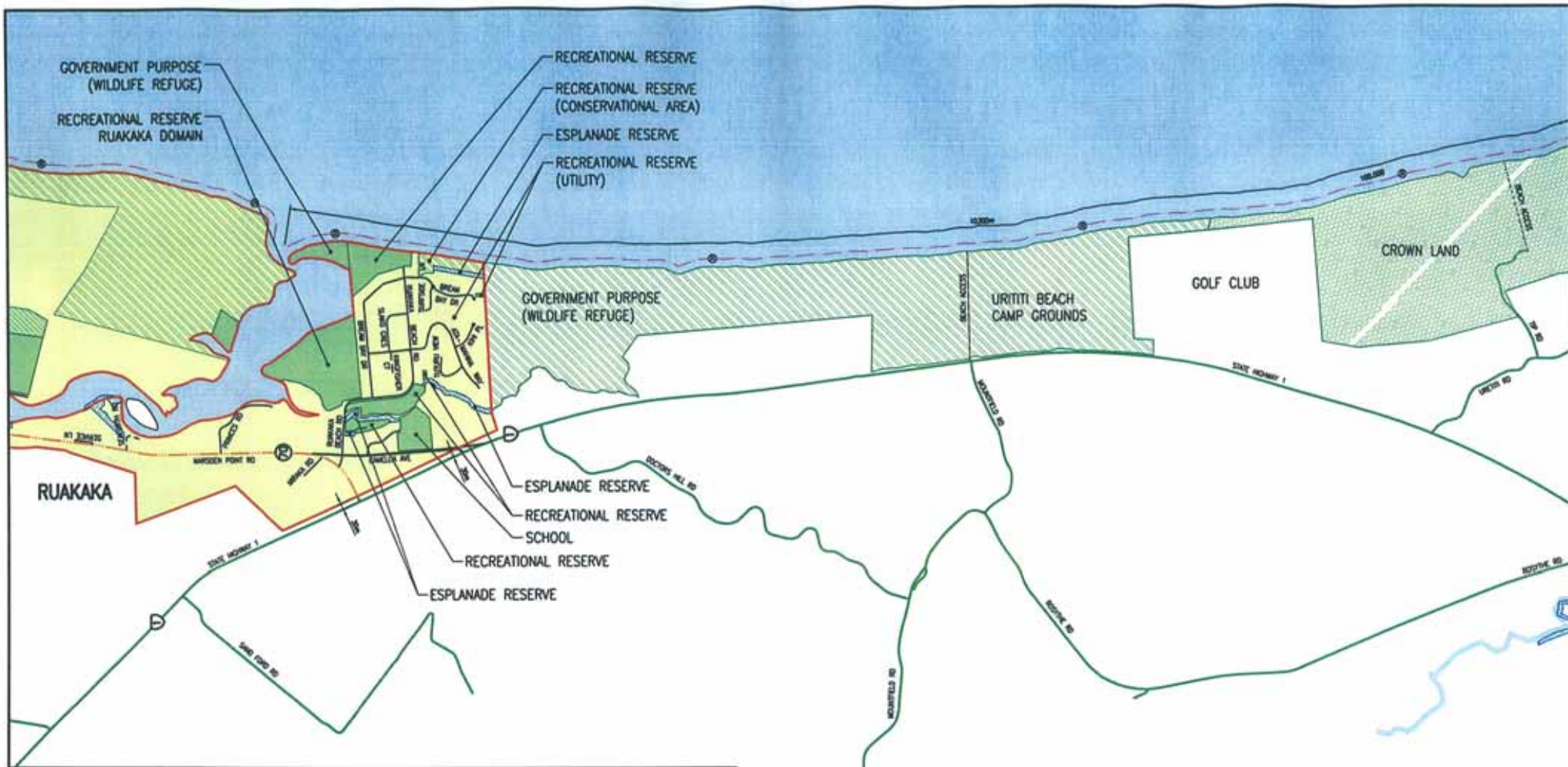

LEGEND

- ROADS THAT HAVE A SPEED LIMIT OF 30 km/h.
- ROADS THAT HAVE A VARIABLE SPEED LIMIT OF 40 km/h, ROADS WITHIN A SCHOOL ZONE WHICH REDUCE TO 40 km/h DURING THE SCHOOL DAY.
- BOUNDARY OF THE URBAN TRAFFIC AREAS THAT HAVE A SPEED LIMIT OF 50 km/h, EXCEPT FOR ROADS OR AREAS MARKED WITH A DIFFERENT SPEED LIMIT.
- ROADS THAT HAVE A SPEED LIMIT OF 6 km/h DURING WINTER AND 11 km/h DURING THE SUMMER HOLIDAY PERIOD. SUMMER HOLIDAY PERIOD STARTS THE FRIDAY BEFORE LABOUR WEEKEND AND ENDS TUESDAY AFTER EASTER WEEKEND.
- ROADS THAT HAVE A SPEED LIMIT OF 80 km/h.
- ROADS THAT HAVE A SPEED LIMIT OF 70 km/h.
- ROADS THAT HAVE A SPEED LIMIT OF 90 km/h.
- ROADS THAT HAVE A SPEED LIMIT OF 100 km/h.
- STATE HIGHWAYS, REFER TO THE TRANSIT NEW ZEALAND SPEED LIMIT BYLAW FOR SPEED LIMITS.
- PRIVATE (PVT) ROAD.
- DISTRICT BOUNDARY WHERE IT ADJUTS TO AN ADJACENT TERRITORIAL LOCAL AUTHORITY.
- DISTANCE IN METRES FROM THE CENTRELINE OF AN INTERSECTING ROAD OR A GEOGRAPHICAL FEATURE SHOWN ON THE MAP TO THE SPEED LIMIT BOUNDARY.

WHANGAREI DISTRICT COUNCIL SPEED LIMITS BYLAW

SCALE BAR: 0 100 200 METRES

1. SCALES SHOWN ON THIS MAP ARE APPROXIMATE.
2. DIMENSIONS SHOW THE BOUNDARIES OF A SPEED LIMIT FOR THE PURPOSE OF THE BYLAW.
3. SPEED LIMIT BOUNDARIES THAT CROSS A ROAD DO SO AT RIGHT ANGLES FROM ONE SIDE TO THE OPPOSITE SIDE OF THE ROAD BY THE SHORTEST DISTANCE.
4. A SPEED LIMIT BOUNDARY MARKED ALONG A ROAD IS DEEMED TO RUN ALONG THE CARRIAGEWAY EDGE OF THAT ROAD UNLESS DIMENSIONED OR SHOWN OTHERWISE.
5. WHERE NO DIMENSION OR DISTANCE IS GIVEN OR SHOWN WHEN THE SPEED LIMIT CROSSES A ROAD AT A SIDE ROAD, THE SPEED LIMIT IS DEEMED TO CROSS THE ROAD AT THE EXTENSION OF THE SIDE ROAD CARRIAGEWAY EDGE.
6. WHERE THE BOUNDARY BETWEEN THE WHANGAREI DISTRICT AND KAPARA DISTRICT AND THE NORTH DISTRICT ROADS ALONG A ROAD, THIS PLAN AND BYLAW APPLY TO THE WHOLE WIDTH OF THE ROAD.
7. WHERE A ROAD CROSSES UNDER OR OVER A STATE HIGHWAY OR EXPRESSWAY, THE SPEED LIMIT ON THAT ROAD AT THAT LOCATION IS DEEMED TO BE THE SAME AS FOR THE ADJACENT SECTIONS OF EITHER SIDE OF THE STATE HIGHWAY OR EXPRESSWAY UNLESS DIMENSIONED OR SHOWN OTHERWISE.
8. ALL WHANGAREI DISTRICT COUNCIL ROADS SHOWN ON THIS MAP OUTSIDE THE URBAN TRAFFIC AREAS HAVE A SPEED LIMIT OF 100 km/h, UNLESS MARKED WITH A DIFFERENT SPEED LIMIT.
9. SPEED LIMITS ON STATE HIGHWAYS ARE NOT PART OF THIS BYLAW. THEY ARE SHOWN ON THIS MAP FOR INFORMATION ONLY. REFER TO TRANSIT NEW ZEALAND SPEED LIMIT BYLAW FOR SPEED LIMITS ON STATE HIGHWAYS.
10. THIS MAP IS PART OF THE WHANGAREI DISTRICT COUNCIL SPEED LIMIT BYLAW 2000.
11. REFER TO SCHEDULES:
 - NOC 34/1 TO 34/29; NOC 35/1; NOC 36/1 TO 36/12; NOC 37/1 TO 37/8; NOC 38/1; AND NOC 313/1 TO 313/7.

KEY

	RECREATIONAL RESERVE (NOC)
	RECREATIONAL RESERVE (CROWN)
	RECREATIONAL RESERVE (DOC)
	RIVER
	ESPLANADE
	WATER LAKE

NOTE:
ALL OTHER LAND IS PRIVATE PROPERTY



**RUAKAKA SOUTH
DISTRICT SPEED LIMIT LOCATIONS
WDC 08/01 SHEET 21C**

DATE: 20/05/08
SCALE: 1:20,000

KEY	
	RECREATIONAL RESERVE (NOC)
	RECREATIONAL RESERVE (DROWN)
	RECREATIONAL RESERVE (DOC)
	RIVER
	ESPLANADE
	MARINE LAND

NOTE: ALL OTHER LAND IS PRIVATE PROPERTY

WHANGAREI DISTRICT COUNCIL SPEED LIMITS BYLAW

SCALE BAR:

1. SCALES SHOWN ON THIS MAP ARE APPROXIMATE.
2. DIMENSIONS SHOW THE BOUNDARIES OF A SPEED LIMIT FOR THE PURPOSE OF THE BYLAW.
3. SPEED LIMIT BOUNDARIES THAT CROSS A ROAD DO SO AT RIGHT ANGLES FROM ONE SIDE TO THE OPPOSITE SIDE OF THE ROAD BY THE SHORTEST DISTANCE.
4. A SPEED LIMIT BOUNDARY MARKED ALONG A ROAD IS DEEMED TO RUN ALONG THE CARRIAGEWAY EDGE OF THAT ROAD UNLESS DIMENSIONS OR SHOWN OTHERWISE.
5. WHERE NO DIMENSION OR DISTANCE IS GIVEN OR SHOWN WHEN THE SPEED LIMIT CROSSES A ROAD AT A SIDE ROAD, THE SPEED LIMIT IS DEEMED TO CROSS THE ROAD AT THE EXTRAPOLATION OF THE ROAD CARRIAGEWAY EDGE.
6. WHERE THE BOUNDARY BETWEEN THE WHANGAREI DISTRICT AND KAWHARU DISTRICT AND THE NORTH-DISTRICT BOUNDARY ALONG A ROAD, THIS PLAN AND BYLAW APPLY TO THE WHOLE WIDTH OF THE ROAD.
7. WHERE A ROAD CROSSES UNDER OR OVER A STATE HIGHWAY OR EXPRESSWAY, THE SPEED LIMIT ON THAT ROAD AT THAT LOCATION IS DEEMED TO BE THE SAME AS FOR THE ADJOINING SECTIONS OF EITHER SIDE OF THE STATE HIGHWAY OR EXPRESSWAY UNLESS DIMENSIONS OR SHOWN OTHERWISE.
8. ALL WHANGAREI DISTRICT COUNCIL ROADS SHOWN ON THIS MAP OUTSIDE THE URBAN TRAFFIC AREAS HAVE A SPEED LIMIT OF 100 km/h, UNLESS MARKED WITH A DIFFERENT SPEED LIMIT.
9. SPEED LIMITS ON STATE HIGHWAYS ARE NOT PART OF THIS BYLAW. THEY ARE SHOWN ON THIS MAP FOR INFORMATION ONLY. REFER TO TRAVEL NEW ZEALAND SPEED LIMIT BYLAWS FOR SPEED LIMITS ON STATE HIGHWAYS.
10. THIS MAP IS PART OF THE WHANGAREI DISTRICT COUNCIL SPEED LIMIT BYLAW 2005.
11. REFER TO SCHEDULES.

LEGEND

- ROADS THAT HAVE A SPEED LIMIT OF 30 km/h.
- ROADS THAT HAVE A VARIABLE SPEED LIMIT OF 40 km/h, ROADS WITHIN A SCHOOL ZONE WHICH DECREASE TO 40 km/h DURING THE SCHOOL DAY.
- BOUNDARY OF THE URBAN TRAFFIC AREAS THAT HAVE A SPEED LIMIT OF 30 km/h, EXCEPT FOR ROADS OR AREAS MARKED WITH A DIFFERENT SPEED LIMIT.
- ROADS THAT HAVE A SPEED LIMIT OF 8 km/h DURING WINTER AND 7 km/h DURING THE SUMMER HOLIDAY PERIOD. SUMMER HOLIDAY PERIOD STARTS THE FRIDAY BEFORE LABOUR WEEKEND AND ENDS FRIDAY AFTER EASTER WEEKEND.
- ROADS THAT HAVE A SPEED LIMIT OF 40 km/h.
- ROADS THAT HAVE A SPEED LIMIT OF 50 km/h.
- ROADS THAT HAVE A SPEED LIMIT OF 60 km/h.
- ROADS THAT HAVE A SPEED LIMIT OF 70 km/h.
- ROADS THAT HAVE A SPEED LIMIT OF 80 km/h.
- ROADS THAT HAVE A SPEED LIMIT OF 100 km/h.
- STATE HIGHWAYS, REFER TO THE TRAVEL NEW ZEALAND SPEED LIMIT BYLAWS FOR SPEED LIMITS.
- PRIVATE (PVT) ROAD.
- DISTRICT BOUNDARY WHERE IT ADJUTS TO AN ADJACENT TERRITORY.
- LOCAL AUTHORITY.

200m

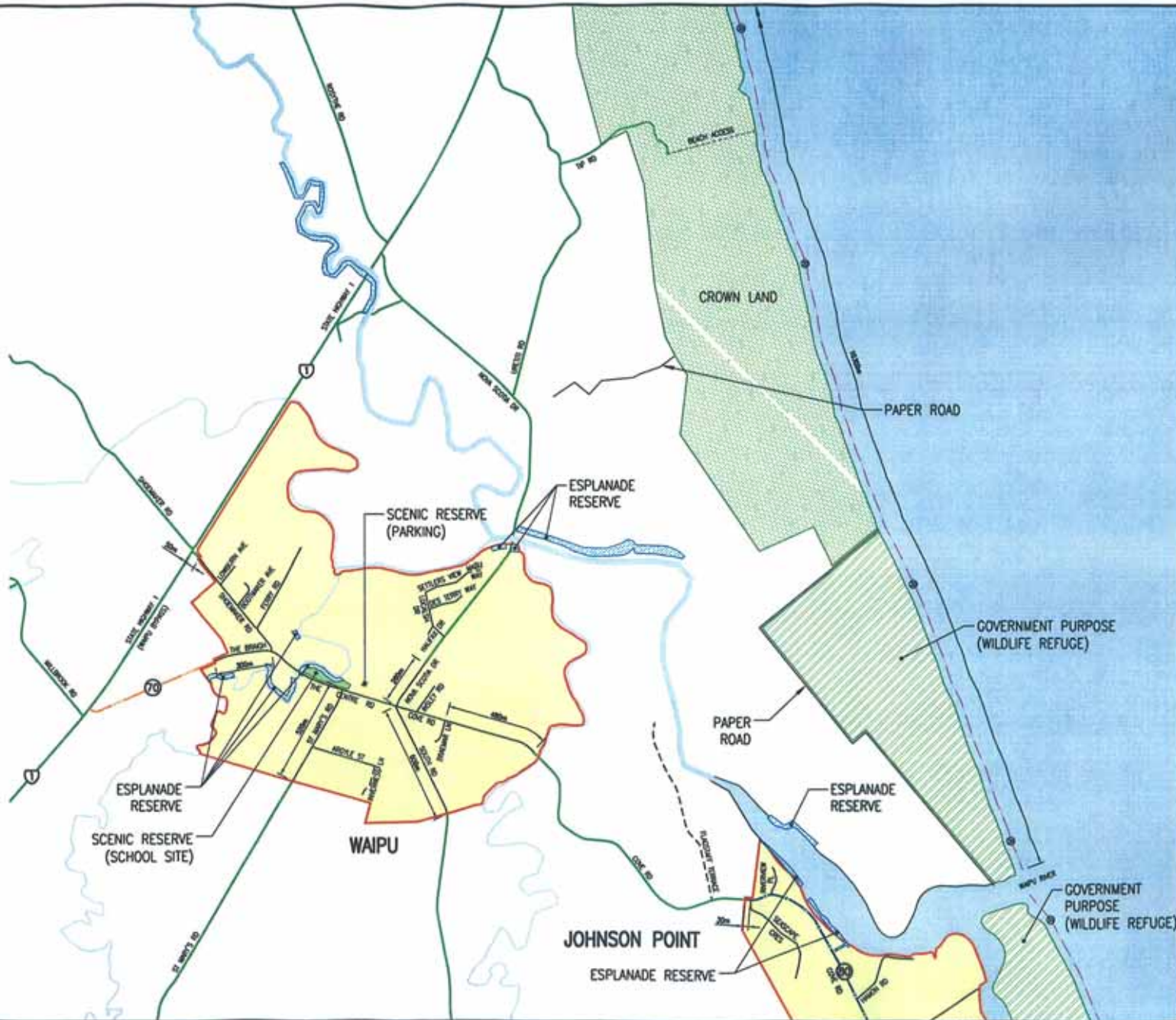

JOHNSON POINT & WAIPU COVE
DISTRICT SPEED LIMIT LOCATIONS
WDC 08/01 SHEET 22A



DATE: 20/05/08
SCALE: 1:20,000



WHANGAREI
DISTRICT COUNCIL

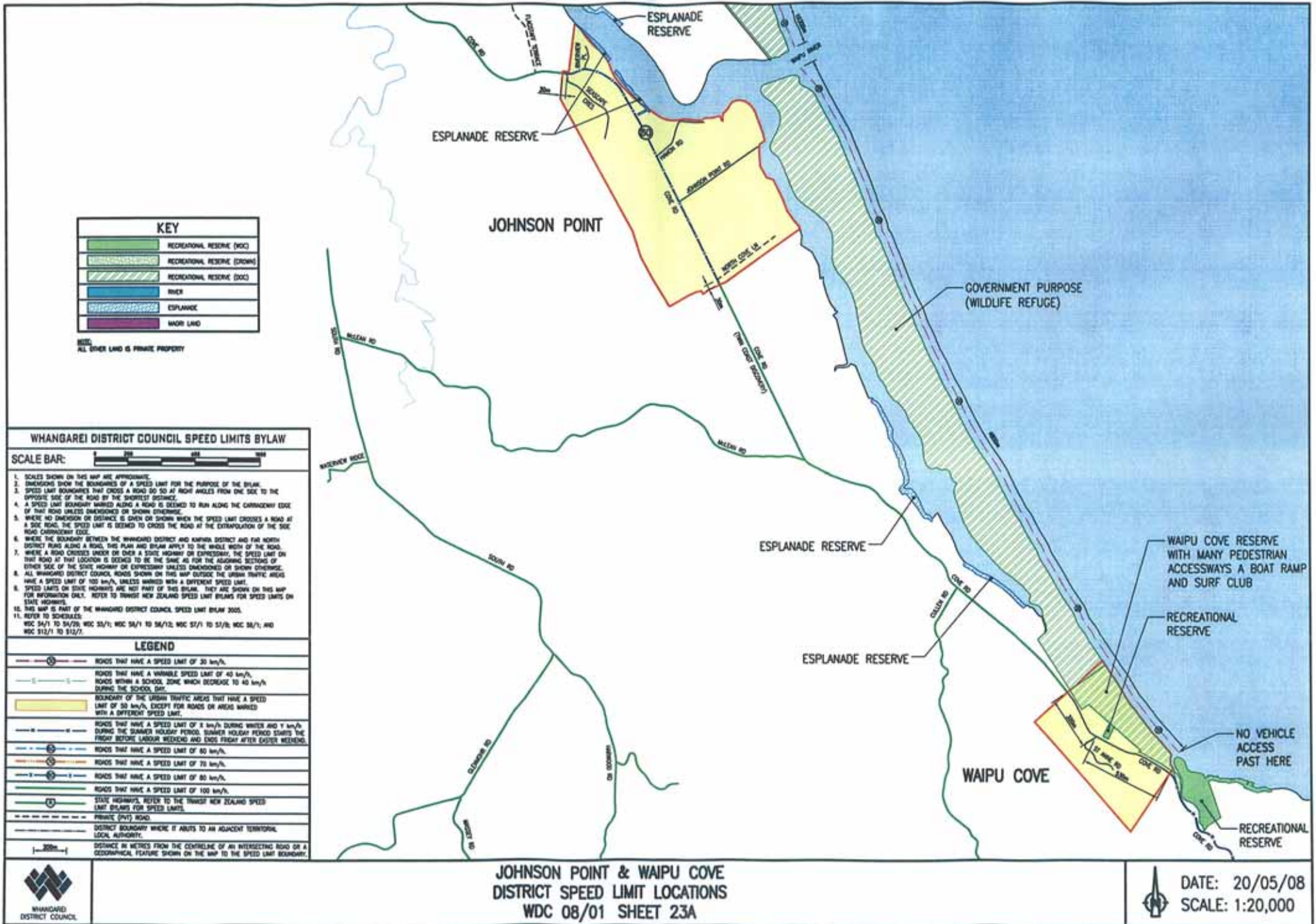

KEY	
	RECREATIONAL RESERVE (DOC)
	RECREATIONAL RESERVE (DROWN)
	RECREATIONAL RESERVE (DOC)
	RIVER
	ESPLANADE
	MAORI LAND

NOTE:
ALL OTHER LAND IS PRIVATE PROPERTY

WHANGAREI DISTRICT COUNCIL SPEED LIMITS BYLAW

SCALE BAR:

1. SCALES SHOWN ON THIS MAP ARE APPROXIMATE.
2. DIMENSIONS SHOW THE BOUNDARIES OF A SPEED LIMIT FOR THE PURPOSE OF THE BYLAW.
3. SPEED LIMIT BOUNDARIES THAT CROSS A ROAD DO SO AT RIGHT ANGLES FROM THE SIDE TO THE OPPOSITE SIDE OF THE ROAD BY THE SHORTEST DISTANCE.
4. A SPEED LIMIT BOUNDARY MARKED ALONG A ROAD IS DEEMED TO RUN ALONG THE CARRIAGEWAY EDGE OF THAT ROAD UNLESS DIMENSIONED OR SHOWN OTHERWISE.
5. WHERE NO DIMENSION OR DISTANCE IS GIVEN OR SHOWN WHEN THE SPEED LIMIT CROSSES A ROAD AT A SIDE ROAD, THE SPEED LIMIT IS DEEMED TO CROSS THE ROAD AT THE EXTRAPOLATION OF THE SIDE ROAD CARRIAGEWAY EDGE.
6. WHERE THE BOUNDARY BETWEEN THE WHANGAREI DISTRICT AND KAWHIA DISTRICT AND THE NORTH DISTRICT RUNS ALONG A ROAD, THIS PLAN AND BYLAW APPLY TO THE WHOLE WIDTH OF THE ROAD.
7. WHERE A ROAD CROSSES UNDER OR OVER A STATE HIGHWAY OR EXPRESSWAY, THE SPEED LIMIT ON THAT ROAD AT THAT LOCATION IS DEEMED TO BE THE SAME AS FOR THE ADJOINING SECTIONS OF EITHER SIDE OF THE STATE HIGHWAY OR EXPRESSWAY UNLESS DIMENSIONED OR SHOWN OTHERWISE.
8. ALL WHANGAREI DISTRICT COUNCIL ROADS SHOWN ON THIS MAP OUTSIDE THE URBAN TRAFFIC AREAS HAVE A SPEED LIMIT OF 100 km/h, UNLESS MARKED WITH A DIFFERENT SPEED LIMIT.
9. SPEED LIMITS ON STATE HIGHWAYS ARE NOT PART OF THIS BYLAW. THEY ARE SHOWN ON THIS MAP FOR INFORMATION ONLY. REFER TO TRAVEL NEW ZEALAND SPEED LIMIT BYLAWS FOR SPEED LIMITS ON STATE HIGHWAYS.
10. THIS MAP IS PART OF THE WHANGAREI DISTRICT COUNCIL SPEED LIMIT BYLAW 2005.
11. REFER TO SCHEDULES:
WDC 54/1 TO 54/29; WDC 55/1; WDC 56/1 TO 56/12; WDC 57/1 TO 57/5; WDC 58/1; AND WDC 512/1 TO 512/7.

LEGEND

- ROADS THAT HAVE A SPEED LIMIT OF 30 km/h.
- ROADS THAT HAVE A VARIABLE SPEED LIMIT OF 40 km/h, ROADS WITHIN A SCHOOL ZONE WHICH DECREASE TO 40 km/h DURING THE SCHOOL DAY.
- BOUNDARY OF THE URBAN TRAFFIC AREAS THAT HAVE A SPEED LIMIT OF 30 km/h, EXCEPT FOR ROADS OR AREAS MARKED WITH A DIFFERENT SPEED LIMIT.
- ROADS THAT HAVE A SPEED LIMIT OF 2 km/h DURING WINTER AND 1 km/h DURING THE SUMMER HOLIDAY PERIOD. SUMMER HOLIDAY PERIOD STARTS THE FRIDAY BEFORE LABOUR WEEKEND AND ENDS FRIDAY AFTER EASTER WEEKEND.
- ROADS THAT HAVE A SPEED LIMIT OF 40 km/h.
- ROADS THAT HAVE A SPEED LIMIT OF 70 km/h.
- ROADS THAT HAVE A SPEED LIMIT OF 80 km/h.
- ROADS THAT HAVE A SPEED LIMIT OF 100 km/h.
- STATE HIGHWAYS. REFER TO THE TRAVEL NEW ZEALAND SPEED LIMIT BYLAWS FOR SPEED LIMITS.
- PRIVATE (PVT) ROAD.
- DISTRICT BOUNDARY WHERE IT ADJUTS TO AN ADJACENT TERRITORIAL LOCAL AUTHORITY.
- DISTANCE IN METRES FROM THE CENTRELINE OF AN INTERSECTING ROAD OR A GEOGRAPHICAL FEATURE SHOWN ON THE MAP TO THE SPEED LIMIT BOUNDARY.

**JOHNSON POINT & WAIPU COVE
DISTRICT SPEED LIMIT LOCATIONS
WDC 08/01 SHEET 23A**

DATE: 20/05/08
SCALE: 1:20,000

KEY	
	RECREATIONAL RESERVE (NOZ)
	RECREATIONAL RESERVE (DRAIN)
	RECREATIONAL RESERVE (DOC)
	RIVER
	ESPLANADE
	WATER LAND

NOTE:
ALL OTHER LAND IS PRIVATE PROPERTY

WHANGAREI DISTRICT COUNCIL SPEED LIMITS BYLAW

SCALE BAR:

1. SCALES SHOWN ON THIS MAP ARE APPROXIMATE.
2. DIMENSIONS SHOW THE BOUNDARIES OF A SPEED LIMIT FOR THE PURPOSE OF THE BYLAW.
3. SPEED LIMIT BOUNDARIES THAT CROSS A ROAD DO SO AT RIGHT ANGLES FROM ONE SIDE TO THE OPPOSITE SIDE OF THE ROAD BY THE SHORTEST DISTANCE.
4. A SPEED LIMIT BOUNDARY MARKED ALONG A ROAD IS DEEMED TO RUN ALONG THE CURBWAY EDGE OF THAT ROAD UNLESS DIMENSIONED OR SHOWN OTHERWISE.
5. WHERE NO DIMENSION OR DISTANCE IS GIVEN OR SHOWN WHEN THE SPEED LIMIT CROSSES A ROAD AT A SIDE ROAD, THE SPEED LIMIT IS DEEMED TO CROSS THE ROAD AT THE EXTENSION OF THE SIDE ROAD CURBWAY EDGE.
6. WHERE THE BOUNDARY BETWEEN THE WHANGAREI DISTRICT AND HARANGA DISTRICT AND FIFTY NORTH DISTRICT RUNS ALONG A ROAD, THIS PLAN AND BYLAW APPLY TO THE WHOLE WIDTH OF THE ROAD.
7. WHERE A ROAD CROSSES UNDER OR OVER A STATE HIGHWAY OR EXPRESSWAY, THE SPEED LIMIT ON THIS ROAD AT THAT LOCATION IS DEEMED TO BE THE SAME AS FOR THE ADJOINING SECTIONS OF EITHER SIDE OF THE STATE HIGHWAY OR EXPRESSWAY UNLESS DIMENSIONED OR SHOWN OTHERWISE.
8. ALL WHANGAREI DISTRICT COUNCIL ROADS SHOWN ON THIS MAP OUTSIDE THE URBAN TRAFFIC AREAS HAVE A SPEED LIMIT OF 100 km/h, UNLESS MARKED WITH A DIFFERENT SPEED LIMIT.
9. SPEED LIMITS ON STATE HIGHWAYS ARE NOT PART OF THIS BYLAW. THEY ARE SHOWN ON THIS MAP FOR INFORMATION ONLY. REFER TO TRAVEL NEW ZEALAND SPEED LIMIT BYLAWS FOR SPEED LIMITS ON STATE HIGHWAYS.
10. THIS MAP IS PART OF THE WHANGAREI DISTRICT COUNCIL SPEED LIMIT BYLAW 2005.
11. REFER TO SCHEDULES:
WDC 54/1 TO 54/26; WDC 55/1; WDC 56/1 TO 56/12; WDC 57/1 TO 57/6; WDC 58/1; AND WDC 512/1 TO 512/7.

LEGEND

- ROADS THAT HAVE A SPEED LIMIT OF 30 km/h.
- ROADS THAT HAVE A VARIABLE SPEED LIMIT OF 40 km/h, ROADS WITHIN A SCHOOL ZONE WHICH REDUCE TO 40 km/h DURING THE SCHOOL DAY.
- BOUNDARY OF THE URBAN TRAFFIC AREAS THAT HAVE A SPEED LIMIT OF 50 km/h, EXCEPT FOR ROADS OR AREAS MARKED WITH A DIFFERENT SPEED LIMIT.
- ROADS THAT HAVE A SPEED LIMIT OF 8 km/h DURING WINTER AND 1 km/h DURING THE SUMMER HOLIDAY PERIOD. SUMMER HOLIDAY PERIOD STARTS THE FRIDAY BEFORE LABOUR WEEKEND AND ENDS FRIDAY AFTER EASTER WEEKEND.
- ROADS THAT HAVE A SPEED LIMIT OF 80 km/h.
- ROADS THAT HAVE A SPEED LIMIT OF 70 km/h.
- ROADS THAT HAVE A SPEED LIMIT OF 60 km/h.
- ROADS THAT HAVE A SPEED LIMIT OF 100 km/h.
- STATE HIGHWAYS. REFER TO THE TRAVEL NEW ZEALAND SPEED LIMIT BYLAWS FOR SPEED LIMITS.
- PRIVATE (PVI) ROAD.
- DISTRICT BOUNDARY WHERE IT ADJUTS TO AN ADJACENT TERRITORIAL LOCAL AUTHORITY.

0 200m

DISTANCE IN METRES FROM THE CENTRELINE OF AN INTERSECTING ROAD OR A GEOGRAPHICAL FEATURE SHOWN ON THE MAP TO THE SPEED LIMIT BOUNDARY.

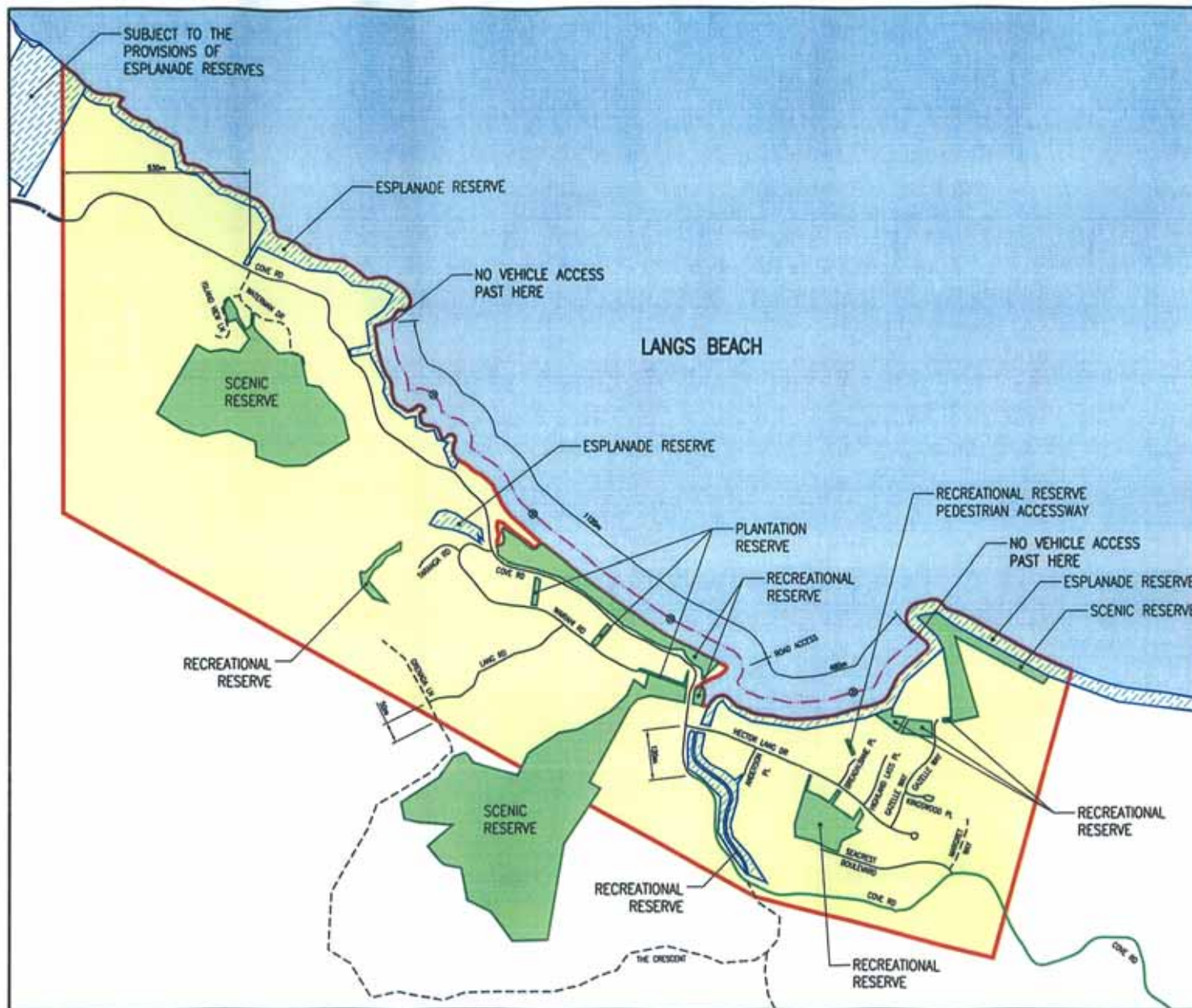

LANGS BEACH
DISTRICT SPEED LIMIT LOCATIONS
WDC 08/01 SHEET 23B



DATE: 20/05/08
SCALE: 1:10,000



WHANGAREI
DISTRICT COUNCIL