

Resource Areas

-  Flood Susceptible Areas
-  Mineral Extraction Areas
-  Mining Hazard Area 1
-  Mining Hazard Area 2
-  Mining Hazard Area 3
-  Notable Landscape Area
-  Outstanding Landscape Area
-  Outstanding Natural Features
-  Goat Control Areas
-  Scheduled Area or Overlay Area
-  Helicopter Hovering Area
-  Runway
-  Air Noise Boundary
-  Outer Control Boundary
-  Coastal Hazard 1
-  Coastal Hazard 2
-  Esplanade Priority Area
-  Building Line Restriction
-  Sites of Significance to Maori
-  Heritage Buildings, Sites, Objects (Built Heritage)
-  Scheduled Historic Area
-  Public and Notable Trees
-  Outstanding Natural Features
-  Coastline

NOTE: Public and Notable Trees are subject to Proposed Plan Change 129 Notable and Public Trees, with legal effect from 09 May 2018.

Refer to Council website for details of PC129.

Northpower Disclaimer
 This map is for indicative and planning purposes only.
 This map is not to be used in place of a cable location service. Northpower provides this service free of charge.

The coastline indicates the mean high water spring (MHWS), which also indicates the jurisdictional boundary between the Northland Regional Council and the Whangarei District Council

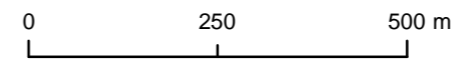
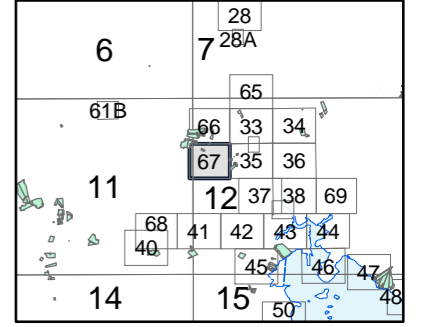

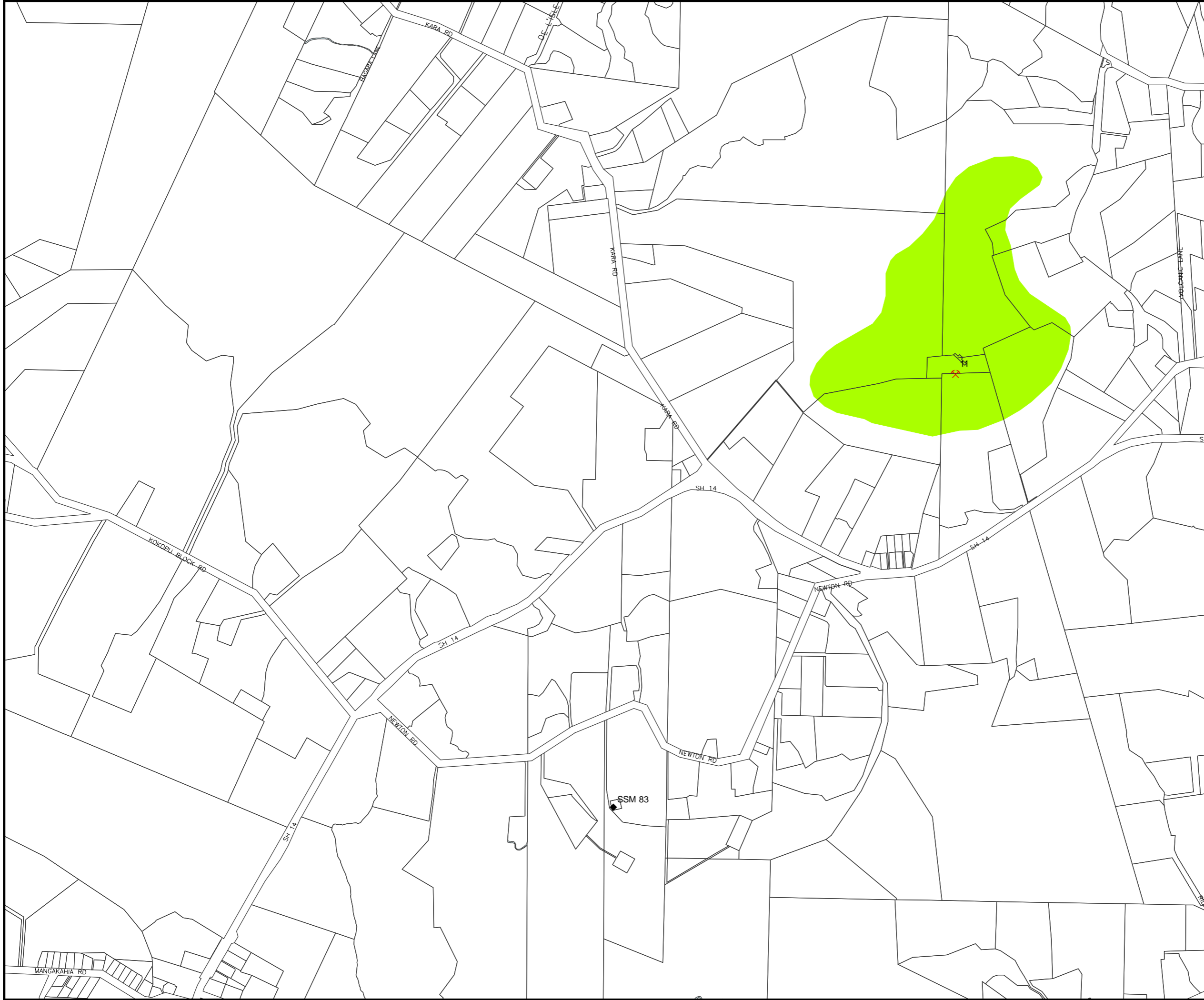

Resource Areas

-  Flood Susceptible Areas
-  Mineral Extraction Areas
-  Mining Hazard Area 1
-  Mining Hazard Area 2
-  Mining Hazard Area 3
-  Notable Landscape Area
-  Outstanding Landscape Area
-  Outstanding Natural Features
-  Goat Control Areas
-  Scheduled Area or Overlay Area
-  Helicopter Hovering Area
-  Runway
-  Air Noise Boundary
-  Outer Control Boundary
-  Coastal Hazard 1
-  Coastal Hazard 2
-  Esplanade Priority Area
-  Building Line Restriction
-  Sites of Significance to Maori
-  Heritage Buildings, Sites, Objects (Built Heritage)
-  Scheduled Historic Area
-  Public and Notable Trees
-  Outstanding Natural Features
-  Coastline

NOTE: Public and Notable Trees are subject to Proposed Plan Change 129 Notable and Public Trees, with legal effect from 09 May 2018.

Refer to Council website for details of PC129.

Northpower Disclaimer
 This map is for indicative and planning purposes only. This map is not to be used in place of a cable location service. Northpower provides this service free of charge.

The coastline indicates the mean high water spring (MHS), which also indicates the jurisdictional boundary between the Northland Regional Council and the Whangarei District Council

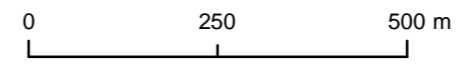
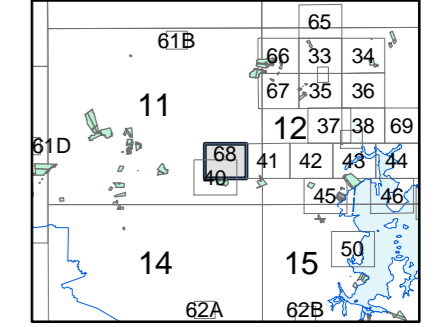

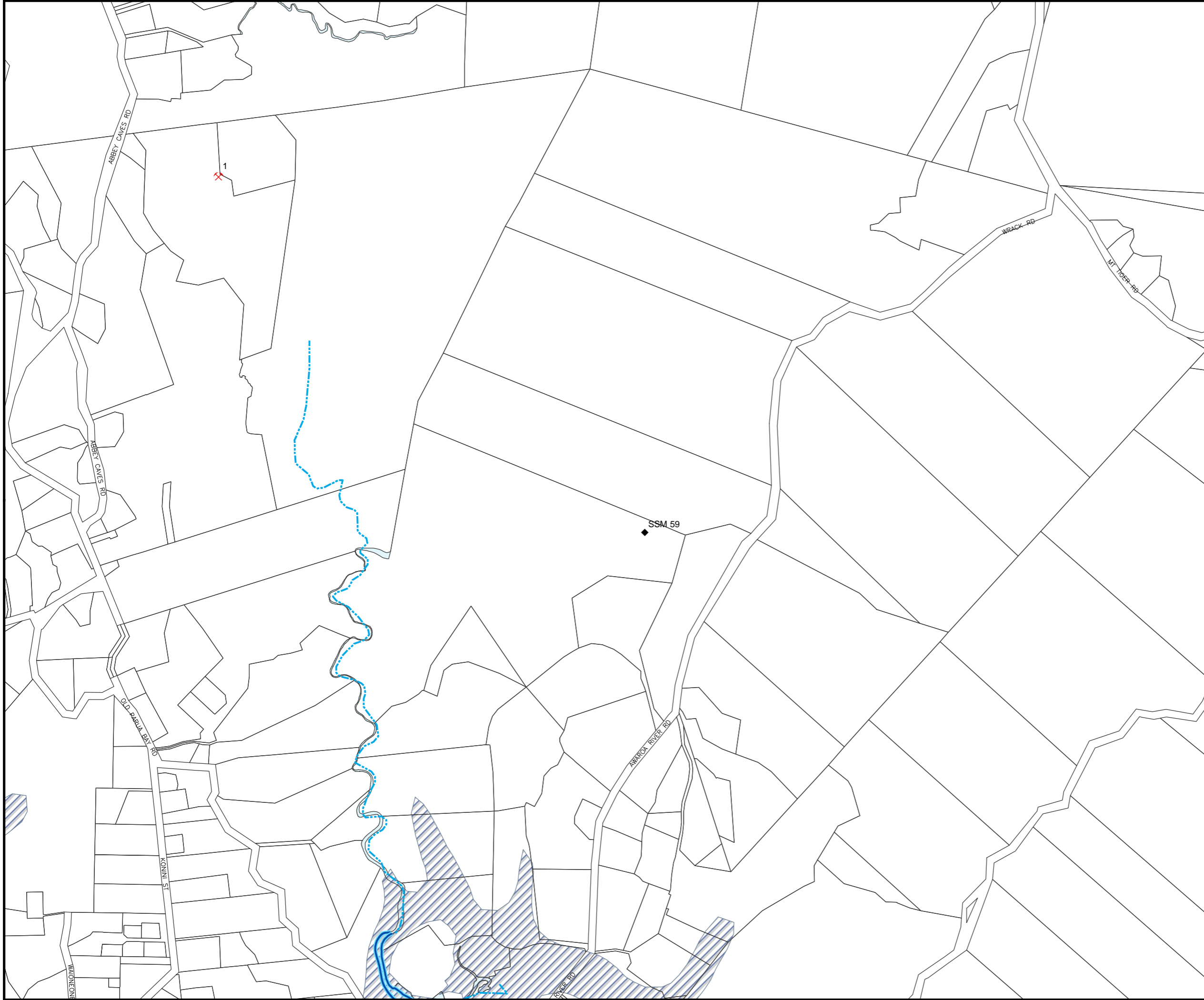

Resource Areas

-  Flood Susceptible Areas
-  Mineral Extraction Areas
-  Mining Hazard Area 1
-  Mining Hazard Area 2
-  Mining Hazard Area 3
-  Notable Landscape Area
-  Outstanding Landscape Area
-  Outstanding Natural Features
-  Goat Control Areas
-  Scheduled Area or Overlay Area
-  Helicopter Hovering Area
-  Runway
-  Air Noise Boundary
-  Outer Control Boundary
-  Coastal Hazard 1
-  Coastal Hazard 2
-  Esplanade Priority Area
-  Building Line Restriction
-  Sites of Significance to Maori
-  Heritage Buildings, Sites, Objects (Built Heritage)
-  Scheduled Historic Area
-  Public and Notable Trees
-  Outstanding Natural Features
-  Coastline

NOTE: Public and Notable Trees are subject to Proposed Plan Change 129 Notable and Public Trees, with legal effect from 09 May 2018.

Refer to Council website for details of PC129.

Northpower Disclaimer
 This map is for indicative and planning purposes only. This map is not to be used in place of a cable location service. Northpower provides this service free of charge.
 The coastline indicates the mean high water spring (MHWS), which also indicates the jurisdictional boundary between the Northland Regional Council and the Whangarei District Council

